

Section 20: Hardware, Terminals & Tape

Sub-Section	Page
Wire Nuts554
Screws, Nuts, Etc.556
Terminals561
Ferrules569
Connector Housings572
Terminal Blocks & Accessories574
Pin Headers577
Tape579
Cable Grips580



Descriptive information herein supplied directly by individual manufacturers. Not responsible for opinion-oriented information or typographical errors. Not all products may be in stock or available to all EDGE members. Price is subject to change without notice. Restrictions may apply. We reserve the right to limit quantities to stock on hand.

Hardware, Terminals & Tape - Wire Nuts



Twister® Wire Connectors

Ribbed cap provides a secure grip and fast fingertip starts. Swept wings offer extra leverage and less effort for large wire combinations. Hexagonal shape accommodates standard nutdriver for tool installation. Live-action, square-wire spring locks onto wire for safe, secure connections. Deep skirt helps protect against flash-over and turned-back strands for maximum dielectric protection. Easily removed for repeat usage on same size or larger wire combinations. Tough, UL 94V-2 flame-retardant shell rated at 105°C [221°F].



Part #	QTY	Model	Color	Wire Comb. Range (in.)	Wire Comb. Range (mm)
30-141	Box of 50	341®	Tan	600V* No. 22 thru 8 AWG Min. 3 No. 22 Max. 3 No. 10	600V* .64mm DIA to 3.26mm DIA Min.. 97mm² Max. 15.78mm²
30-142	Box of 25	342®	Gray	600V* No. 18 thru 8 AWG Min. 3 No. 14 Max 2 No. 10 with 4 No. 12 Solid	600V* 1.02mm DIA to 3.26mm DIA Min. 6.24mm Max. 23.76mm
30-341	Box of 100	341®	Tan	600V* No. 22 thru 8 AWG Min. 3 No. 22 Max. 3 No. 10	600V* .64mm DIA to 3.26mm DIA Min.. 97mm² Max. 15.78mm²
30-341J	Jar of 750	341®	Tan	600V* No. 22 thru 8 AWG Min. 3 No. 22 Max. 3 No. 10	600V* .64mm DIA to 3.26mm DIA Min.. 97mm² Max. 15.78mm²
30-342	Box of 50	342®	Gray	600V* No. 18 thru 8 AWG Min. 3 No. 14 Max 2 No. 10 with 4 No. 12 Solid	600V* 1.02mm DIA to 3.26mm DIA Min. 6.24mm Max. 23.76mm
30-541	Carton of 1,000	341®	Tan	600V* No. 22 thru 8 AWG Min. 3 No. 22 Max. 3 No. 10	600V* .64mm DIA to 3.26mm DIA Min.. 97mm² Max. 15.78mm²
30-641	Bag of 500	341®	Tan	600V* No. 22 thru 8 AWG Min. 3 No. 22 Max. 3 No. 10	600V* .64mm DIA to 3.26mm DIA Min.. 97mm² Max. 15.78mm²
30-642	Bag of 250	342®	Gray	600V* No. 18 thru 8 AWG Min. 3 No. 14 Max 2 No. 10 with 4 No. 12 Solid	600V* 1.02mm DIA to 3.26mm DIA Min. 6.24mm Max. 23.76mm

Twister® DB Plus™ Wire Connector

Smallest wet location/direct burial connector with widest wire range - covers wire sizes from 20 AWG through 12 AWG. Non-hardening sealant completely seals out moisture to protect conductors from fungus and corrosion. Compact, one-piece design features ribbed cap, swept wings and hexagonal head for easy installation by hand or with standard nutdriver. Live-action, square-wire spring locks onto wire for safe, secure connections. Deep skirt provides maximum dielectric strength. Blue. Wire combination range is 600V, No. 22 to 8 AWG, Min. 1 No. 18 & 1 No. 20; Max 1 No. 10 & 2 No. 12.



Part #	QTY
30-060	Card of 2
30-760	Card of 10
30-160	Card of 25
30-260	Box of 100



Wire-Nut® Wire Connectors

Full range of wire sizes from 22 through 8 AWG. Fixed, square-wire spring creates its own threads - maintains a secure positive grip that will not relax over time. No pre-twisting required - positive grip design provides fast, easy installation. Deep, wide skirt helps protect against flash-over and turned-back strands for maximum dielectric protection. Reusable for easy circuit changes and additions. *1,000 max in fixtures & signs.



Part #	Color	Wire Combination Range	Wire Combination Range (mm)	QTY
30-071	Gray	300V No. 22 to 16 AWG Min. 2 No. 22 - Max. 2 No. 16	300V .64mm DIA to 1.29mm DIA Min. 65mm² - Max. 2.62mm²	Box of 100
30-072	Blue	300V No. 22 to 14 AWG Min. 2 No. 22 - Max. 2 No. 16	300V .64mm DIA to 1.63mm DIA Min. 65mm² - Max. 3.93mm²	Box of 100
30-073	Orange	600V No. 22 to 14 AWG Min. 1 No. 18 & 1 No. 20 - Max. 4 No. 16 & No. 20	600V .64mm DIA to 1.63mm DIA Min. 164mm² - Max. 5.76mm²	Box of 100
30-073J	Orange	600V No. 22 to 14 AWG Min. 1 No. 18 & 1 No. 20 - Max. 4 No. 16 & No. 20	600V .64mm DIA to 1.63mm DIA Min. 164mm² - Max. 5.76mm²	Jar of 300
30-074	Yellow	600V* No. 18 to 12 AWG Min. 2 No. 18 Max. 4 No. 14 & 1 No. 18	600V* 1.02mm DIA to 2.05mm DIA Min. 1.64mm² - Max. 9.14mm²	Box of 100
30-074J	Yellow	600V* No. 18 to 12 AWG Min. 2 No. 18 Max. 4 No. 14 & 1 No. 18	600V* 1.02mm DIA to 2.05mm DIA Min. 1.64mm² - Max. 9.14mm²	Jar of 175
30-076	Red	600V* No. 18 to 10 Awg Min. 2 No. 14 - Max. 2 No. 10 & 2 No. 12	600V* 1.02mm DIA to 2.05mm DIA Min. 2.59mm² - Max. 17.14mm²	Box of 100

WeatherProof™ and UnderGround™ Wire Connectors

Silicone-based sealant protects against moisture and corrosion. UL listed to 486D for use in damp/wet locations or direct burial. Easy to apply pre-filled twist-on connectors. Handles wire sizes from #20 to #6 AWG copper conductors. Suitable for interior and exterior electrical connections exposed to rain or damp conditions.

Part #	Color	Wire Combination Range	Availability
30-061	Blue/Orange	600V, No. 22 to 12 AWG, Min 2 No. 20, Max 2 No. 14	Card of 6
30-161	Blue/Orange	600V, No. 22 to 12 AWG, Min 2 No. 20, Max 2 No. 14	Card of 25
30-261	Blue/Orange	600V, No. 22 to 12 AWG, Min 2 No. 20, Max 2 No. 14	Box of 100
30-361	Blue/Orange	600V, No. 22 to 12 AWG, Min 2 No. 20, Max 2 No. 14	Box of 1,000
30-062	Blue/Red	600V, No. 18 to 8 AWG, Min. 2 No. 18, Max. 3 No. 10	Card of 5
30-162	Blue/Red	600V, No. 18 to 8 AWG, Min. 2 No. 18, Max. 3 No. 10	Card of 20
30-262	Blue/Red	600V, No. 18 to 8 AWG, Min. 2 No. 18, Max. 3 No. 10	Box of 100
30-362	Blue/Red	600V, No. 18 to 8 AWG, Min. 2 No. 18, Max. 3 No. 10	Box of 1,000
30-063	Blue/Dr. Blue	600V, No. 16 to 6 AWG, Min. 3 No. 14, Max. 2 No. 8 & 1 No. 10	Card of 3
30-163	Blue/Dr. Blue	600V, No. 16 to 6 AWG, Min. 3 No. 14, Max. 2 No. 8 & 1 No. 10	Card of 15
30-263	Blue/Dr. Blue	600V, No. 16 to 6 AWG, Min. 3 No. 14, Max. 2 No. 8 & 1 No. 10	Box of 100
30-363	Blue/Dr. Blue	600V, No. 16 to 6 AWG, Min. 3 No. 14, Max. 2 No. 8 & 1 No. 10	Box of 1,000

Hardware, Terminals & Tape - Wire Nuts



WeatherProof™ and UnderGround™ Wire Connectors (cont.)

UnderGround™ Wire Connectors

Suitable for use in a wide variety of direct burial and wet location electrical connections.

Part #	Color	Wire Combination Range	Availability
30-060	Blue/Blue	600V, No. 20 to 10 AWG, Min. 2 No. 20, Max. 1 No. 10 & 2 No. 12	Card of 2
30-760	Blue/Blue	600V, No. 20 to 10 AWG, Min. 2 No. 20, Max. 1 No. 10 & 2 No. 12	Card of 10
30-260	Blue/Blue	600V, No. 20 to 10 AWG, Min. 2 No. 20, Max. 1 No. 10 & 2 No. 12	Box of 100
30-360	Blue/Blue	600V, No. 20 to 10 AWG, Min. 2 No. 20, Max. 1 No. 10 & 2 No. 12	Box of 1,000
30-860	Yellow	600V, No. 20 to 10 AWG, Min. 2 No. 20, Max. 1 No. 10 & 2 No. 12	Box of 2,500
30-064	Blue/Dr. Blue	600V, No. 18 to 8 AWG, Min. 2 No. 18, Max. 3 No. 10	Card of 2
30-764	Blue/Dr. Blue	600V, No. 18 to 8 AWG, Min. 2 No. 18, Max. 3 No. 10	Card of 10
30-264	Blue/Dr. Blue	600V, No. 18 to 8 AWG, Min. 2 No. 18, Max. 3 No. 10	Box of 50
30-364	Blue/Dr. Blue	600V, No. 18 to 8 AWG, Min. 2 No. 18, Max. 3 No. 10	Box of 1,000

Term-a-Nut® Terminal Wire Connectors

No tools required - installs quickly without crimping - easily removed for quick changes. Use with single or multiple wires - solid and/or stranded #22 AWG #12 AWG. Highly conductive brass terminal and phosphor-bronze spring for maximum conductivity and smooth performance. Tough, UL 94V-2 flame-retardant shell rated at 105°C (221°F). UL 486A and UL 486C Listed and tested to CSA C22.2 #65 and C22.2 #188.



Part #	Terminal Configurations
30-2906	.250 female disconnect, 20 pieces per pack
30-3901	Assortment, 40 pieces per pack

Term-a-Nut® Pigtail Connectors

Ultra-flexible 6-in. lead allows for easy positioning in outlet box - reduces stress on device, wires and connection. Wide range of wire combinations - #18 through #12 AWG solid or stranded conductors. Brass adapter for strong, conductive transition from spring to lead wire. Brass-alloy terminals with locking tabs for fast, efficient device connection. UL 486A and UL 486C Listed and tested to CSA standard C22.2 #65 and C22.2 #188. Wire range: red/green shell - Min. 2 #18 AWG with 1 #14 AWG. Max. 4 #12 AWG. *Includes 3 red shells with white wire, 3 red shells with black wire and 3 green shells with green wire.



Part #	Shell Color	Wire Color	Terminal End	Quantity/Bag
30-3170	Red	White	#10 fork	10
30-3370	Red	White	#10 fork	10
30-3171	Red	Black	#10 fork	25
30-3371	Red	Black	#10 fork	10
30-3172	Red	White	Stripped end	25
30-3173	Red	Black	Stripped end	25
30-3180	Green	Green	#10 fork	25
30-3380	Green	Green	#10 fork	10
30-3181	MultiPak*	-	-	-

In-Sure™ Push-In Wire Connectors

Clear shell makes connection easy to inspect. Low wire insertion force for fast, easy connections. No-twist connection reduces repetitive motion fatigue. Check port for continuity testing. Electrolytic tin-plated internal copper bus for high conductivity. UL 467 Listed for grounding and bonding applications.



Part #	Model	Color	Ports	Length In. (mm)	Width In. (mm)	Height In. (mm)	QTY
30-084J	84	Red	2	.355 (9.02)	.434 (11.02)	.729 (18.52)	Jar of 300
30-085J	85	Orange	3	.355 (9.02)	.591 (15.01)	.729 (18.52)	Jar of 250
30-086J	86	Yellow	4	.355 (9.02)	.748 (18.99)	.729 (18.52)	Jar of 200
30-087J	87	Gray	5	.355 (9.02)	.907 (23.03)	.729 (18.52)	Jar of 150
30-088J	88	Blue	6 Stacked	.607 (15.42)	.603 (15.32)	.729 (18.52)	Jar of 100
30-090J	90	Black	8	.355 (9.02)	1.38 (35.03)	.717 (18.21)	Jar of 100
30-184	84	Red	2	.355 (9.02)	.434 (11.02)	.729 (18.52)	Box of 1,000
30-185	85	Orange	3	.355 (9.02)	.591 (15.01)	.729 (18.52)	Box of 1,000
30-186	86	Yellow	4	.355 (9.02)	.748 (18.99)	.729 (18.52)	Box of 1,000
30-187	87	Gray	5	.355 (9.02)	.907 (23.03)	.729 (18.52)	Box of 1,000
30-188	88	Blue	6 Stacked	.607 (15.42)	.603 (15.32)	.729 (18.52)	Box of 1,000
30-190	90	Black	8	.355 (9.02)	1.38 (35.03)	.717 (18.21)	Box of 1,000
30-684	84	Red	2	.355 (9.02)	.434 (11.02)	.729 (18.52)	Box of 5,000
30-685	85	Orange	3	.355 (9.02)	.591(15.01)	.729 (18.52)	Box of 5,000
30-686	86	Yellow	4	.355 (9.02)	.748 (18.99)	.729 (18.52)	Box of 5,000
30-687	87	Gray	5	.355 (9.02)	.907 (23.03)	.729 (18.52)	Box of 5,000
30-688	88	Blue	6 Stacked	.607 (15.42)	.603 (15.32)	.729 (18.52)	Box of 5,000
30-690	90	Black	8	.355 (9.02)	1.38 (35.03)	.717 (18.21)	Box of 5,000

Hardware, Terminals & Tape - Wire Nuts



Wire Nut Connectors

Molded of a pliable flame retardant thermoplastic that is virtually indestructible in normal usage. The fully-seated square wire spring on the inside forms its own threads to draw the connector completely onto wire combinations. The connectors tighten all the way, without ratcheting, to indicate splices are complete and they back off easily for repeat usage. Temperature Rating: 105c / Electrical rating: 300 volts.

Part #	Gauge	Color	Min	Max
1601	22-16	Grey	1 # 20 & 1 # 22	2 # 16
1602	22-14	Blue	3 # 20	3 # 16
1603	22-14	Orange	3 # 20	3 # 16 & 1 # 18
1604	18-12	Yellow	1 # 14 & 1 # 18	4 no. 14 & 1 no. 18
1605	18-10	Red	2 # 14	4 # 10

Push-Wire Connectors

No twist, push wire connectors for solid and stranded copper wire. The clear housing means you can see the firm connection of solid or stranded conductors. They hold each wire individually, eliminating loose connections. They are touch-proof and rated to 105°C. No more twisting and taping required. Simply strip the wire - insert the conductor and you're finished. The integrated test port allows for continuity testing without re-insertion. UL/CSA certified for 600 volts (1000 volts for fixtures and signs) and current rated to the largest conductor used 12-16 gauge stranded copper (stranding pattern less than or equal to 19) 12-18 gauge solid copper.

Shown in Mini Pack.

Part #	10 Pcs	100 Pcs	Description
1632-BP	1632-14	1632-C	2 Conductor Yellow
1634-BP	1634-14	1634-C	4 Conductor Orange
1636-BP	1636-14	1636-C	6 Conductor Purple
1638-BP	1638-14	1638-C	8 Conductor Dark Grey

Push-Wire Connectors (cont.)

Compact connector - 12-26 gauge 3 conductor terminal blocks with levers - cage clamp connection max continuous usage. Temperature 85°C. Rated for 600 volts 20 amps. Easy to use - strip wire 9-10mm. Use the stripped wire gage on the back of the connector to verify correct strip length. Push up lever and insert conductor. The push down lever to its closed position.

Part #	Description
1633-12	2 pieces
1633-14	10 pieces
1633-36	100 pieces

22-14. Self-stripping electrical connector with sealant filling. The sealant helps to protect against corrosion due to moisture. No wire stripping is required. Simply insert wires and press down with pliers.

Part #	Description
1640-12	2 Pcs
1640-14	10 Pcs



We Also Offer
**Power-Connect™
Grounding
Connectors**



Call Us For More Details

Hardware, Terminals & Tape - Screws, Nuts, Etc.



Split Lock Washers



Part #	Size
MW-411-C	4
MW-412-C	6
MW-413-C	8
MW-414-C	10
MW-415-C	1/4

Nylon Machine Screws



Part #	Size/Thread	Length (in.)	Head (Style)
FN-800-C	2/56	1/4	Round
FN-801-C	2/56	1/2	Round
FN-802-C	4/40	1/4	Round
FN-803-C	4/40	1/2	Round
FN-804-C	4/40	3/4	Round
FN-805-C	6/32	1/4	Round
FN-815-C	2/56	1/4	Binder
FN-816-C	2/56	1/2	Binder
FN-817-C	4/40	1/4	Binder
FN-818-C	4/40	1/2	Binder

Nylon Machine Screws (cont.)

Part #	Size/Thread	Length (in.)	Head (Style)
FN-819-C	4/40	3/4	Binder
FN-820-C	6/32	1/4	Binder
FN-821-C	6/32	3/8	Binder
FN-822-C	6/32	1/2	Binder
FN-823-C	6/32	5/8	Binder
FN-824-C	6/32	3/4	Binder
FN-825-C	8/32	3/8	Binder
FN-826-C	8/32	1/2	Binder
FN-827-C	8/32	3/4	Binder
FN-828-C	10/32	3/4	Binder
FN-829-C	10/32	1	Binder

Wood Screws



Part #	Size/Thread	Length (in.)	Head (Style)
F-027-C	8	1/2	Flat
F-032-C	8	1 1/4	Flat
F-048-C	8	1	Flat
F-047-C	8	1	Round
F-514-C	4	1/2	Round
F-516-C	6	3/4	Round



Hardware, Terminals & Tape - Screws, Nuts, Etc.



Wood Screws (cont.)

Part #	Size/Thread	Length (in.)	Head (Style)
F-517-C	6	1	Round
F-518-C	8	3/4	Round
KF-519	8	1 1/4	Round

Steel-Nickel Plated Machine Screws



Part #	Size/Thread	Length (in)	Head (Style)
F-020-C	4/40	1/4	Binder
F-021-C	4/40	1/2	Binder
F-022-C	4/40	3/4	Binder
F-024-C	8/32	3/8	Binder
F-026-C	8/32	3/4	Binder
F-461-C	2/56	1/4	Round
F-462-C	2/56	1/2	Round
F-463-C	2/56	3/4	Round
F-464-C	3/48	3/4	Round
F-465-C	4/36	1/4	Round
F-466-C	4/36	3/8	Round
F-467-C	4/36	1/2	Round
F-468-C	4/36	3/4	Round
F-469-C	4/40	1/4	Round
F-470-C	4/40	1/2	Round
F-471-C	4/40	3/4	Round
F-472-C	6/32	1/4	Round
F-473-C	6/32	1/2	Round
F-475-C	6/32	1	Round
F-476-C	6/32	1 1/4	Round
F-477-C	6/32	2	Round
F-478-C	8/32	1/4	Round
F-479-C	8/32	3/8	Round
F-480-C	8/32	1/2	Round
F-481-C	8/32	3/4	Round
F-482-C	8/32	1	Round
F-483-C	8/32	1 1/4	Round
F-484-C	10/32	1/2	Round
F-485-C	10/32	3/4	Round
F-486-C	10/32	1	Round
F-487-C	10/32	1 1/2	Round
F-502-C	6/32	3/16	Binder
F-503-C	6/32	1/4	Binder
F-504-C	6/32	3/8	Binder
F-505-C	8/32	5/16	Binder
F-577-C	10/32	1/2	Binder
F-578-C	10/32	3/4	Binder
F-581-C	4/10	3/8	Round
F-582-C	4/40	5/8	Round
F-583-C	6/32	3/8	Round
F-584-C	6/32	5/8	Round
F-591-C	2/56	1/8	Binder
F-592-C	2/56	1/4	Binder
F-593-C	2/56	1/2	Binder
F-594-C	2/56	5/8	Binder
F-621-C	6/32	5/8	Binder
F-622-C	4/40	1/4	Flat
F-623-C	4/40	3/8	Flat
F-624-C	4/40	1/2	Flat
F-625-C	6/32	1/4	Flat

Steel-Nickel Plated Machine Screws (cont.)

Part #	Size/Thread	Length (in)	Head (Style)
F-627-C	6/32	1/2	Flat
F-628-C	6/32	3/4	Flat
F-629-C	8/32	3/8	Flat
F-630-C	8/32	1/2	Flat
F-631-C	8/32	3/4	Flat
F-632-C	10/32	1/2	Flat

Flat Washers



Part #	Description	Size	Thickness (in.)	Inner Dia. (in.)	Outer Dia. (in.)
FW-374-C	Fiber Flat Washer	4	0.03125	0.12	0.25
FW-375-C	Fiber Flat Washer	6	0.03125	0.145	0.25
FW-376-C	Fiber Flat Washer	8	0.03125	0.1875	0.375
FW-377-C	Fiber Flat Washer	10	0.03125	0.192	0.375
MW-400-C	Steel Flat Washer	2	0.018	0.092	0.21875
MW-401-C	Steel Flat Washer	4	0.030	0.125	0.297
MW-403-C	Steel Flat Washer	8	0.049	0.188	0.438
MW-404-C	Steel Flat Washer	10	0.049	0.219	0.500
MW-408-C	Steel Flat Washer	1/4	0.065	0.281	0.625
MW-410-C	Steel Flat Washer	3/8	0.065	0.392	0.750
NW-875-C	Nylon Flat Washer	4	0.062	0.115	0.25
NW-876-C	Nylon Flat Washer	6	0.062	0.14	0.3125
NW-877-C	Nylon Flat Washer	8	0.062	0.171	0.375
NW-878-C	Nylon Flat Washer	10	0.062	0.194	0.375

Sheet Metal Screws



Part #	Size/Thread	Length (in.)	Head (Style)
F-014-C	6/32	1/2	Binder
F-015-C	6/32	3/4	Binder
F-016-C	4/40	3/8	Hex
F-017-C	8/32	5/8	Hex
F-033-C	6/32	1/4	Pan
F-034-C	6	1/2	Pan
F-035-C	6	3/4	Pan
F-036-C	8	1/4	Pan
F-037-C	8	1/2	Pan
F-038-C	8	1	Pan
F-050-C	6	1/2	Hex Washer
F-051-C	8	1/4	Hex Washer
F-052-C	8	3/8	Hex Washer
F-053-C	8	1/2	Hex Washer
F-054-C	6	3/4	Hex Washer
F-055-C	8	5/8	Hex Washer
F-056-C	6	1/4	Hex Washer
F-057-C	6	3/8	Hex Washer

Hardware, Terminals & Tape - Screws, Nuts, Etc.



Sheet Metal Screws (cont.)

Part #	Size/Thread	Length (in.)	Head (Style)
F-058-C	6	5/8	Hex Washer
F-059-C	8	3/4	Hex Washer
F-523-C	4	1/2	Hex
F-524-C	6	1/4	Hex
F-525-C	6	3/8	Hex
F-526-C	6	1/2	Hex
F-527-C	6	3/4	Hex
F-528-C	8	1/4	Hex
F-529-C	8	3/8	Hex
F-530-C	8	1/2	Hex
F-531-C	8	1	Hex
F-532-C	10	3/8	Hex
F-533-C	10	1/2	Hex
F-534-C	10	3/4	Hex
F-596-C	4	1/2	Pan
F-597-C	6	3/8	Pan

Nickel Plated Internal Washers (cont.)

Star Washers

Part #	Size
54-518-0	2
54-528-0	4
54-538-0	6
54-548-0	8
54-558-0	10

Nickel Plated Nuts

Part #	Size
54-516-0	2
54-526-0	4
54-536-0	6
54-546-0	8
54-556-0	10

English Hex Nuts



Part #	Description	Size	Thread	Thickness (in.)	Width (in.)
F-554-C	Nickel Plated Hex Nuts	2	56	1/16	3/16
KF-555	Nickel Plated Hex Nuts	3	48	1/16	3/16
F-556-C	Nickel Plated Hex Nuts	4	36	3/32	1/4
F-557-C	Nickel Plated Hex Nuts	4	40	3/32	1/4
F-559-C	Nickel Plated Hex Nuts	6	32	3/32	1/4
F-560-C	Nickel Plated Hex Nuts	6	32	7/64	5/16
F-561-C	Nickel Plated Hex Nuts	8	32	3/32	1/4
F-562-C	Nickel Plated Hex Nuts	8	32	7/64	5/16
F-563-C	Nickel Plated Hex Nuts	10	32	1/8	3/8
F-564-C	Nickel Plated Hex Nuts	1/4	20	3/16	7/16
FN-853-C	Nylon Hex Nuts	2	56	-	3/16
FN-854-C	Nylon Hex Nuts	4	40	-	1/4
FN-855-C	Nylon Hex Nuts	6	32	-	5/16
FN-856-C	Nylon Hex Nuts	8	32	-	11/32
FN-857-C	Nylon Hex Nuts	10	32	-	3/8

Metric Hardware



Nickel Plated Nuts

Part #	Size (mm)
54-406-0	2 mm
54-416-0	2.6 mm
54-426-0	3 mm
54-436-0	4 mm

Nickel Plated Round Phillips Head Screws

Part #	Size (mm)	Length (mm)
54-400-0	2	6
54-401-0	2	8
54-402-0	2	10
54-403-0	2	12
54-404-0	2	14
54-405-0	2	16
54-410-0	2.6	6
54-411-0	2.6	8
54-412-0	2.6	10
54-413-0	2.6	12
54-414-0	2.6	14
54-415-0	2.6	16
54-420-0	3	6
54-421-0	3	8
54-422-0	3	10
54-423-0	3	12
54-424-0	3	14
54-425-0	3	16
54-430-0	4	6
54-431-0	4	8
54-432-0	4	10
54-433-0	4	12
54-434-0	4	14
54-435-0	4	16



Nickel Plated Internal Washers

Split Washers

Part #	Size
54-519-0	2
54-529-0	4
54-539-0	6
54-549-0	8
54-559-0	10



Hardware, Terminals & Tape - Screws, Nuts, Etc.



Metric Hardware (cont.)



Nickel Plated Flat Washers

Part #	Size (mm)
54-407-0	2 mm
54-417-0	2.6 mm
54-427-0	3 mm
54-437-0	4 mm

Nickel Plated Split and Internal Star Lockwashers



Part #	Size (mm)	Type
54-408-0	2	Internal star
54-409-0	2	Split
54-418-0	2.6	Internal star
54-419-0	2.6	Split
54-428-0	3	Internal star
54-429-0	3	Split
54-438-0	4	Internal star
54-439-0	4	Split

UNC Hardware

Nickel Plated Round Phillips Head Screws

Part #	Size	Length
54-510-0	2-56	1/4"
54-512-0	2-56	1/2"
54-520-0	4-40	1/4"
54-522-0	4-40	1/2"
54-527-0	4-40	3/4"
54-530-0	6-32	1/4"
54-531-0	6-32	3/8"
54-532-0	6-32	1/2"
54-533-0	6-32	5/8"
54-534-0	6-32	3/4"
54-540-0	8/32	1/4"
54-541-0	8-32	3/8"
54-542-0	8-32	1/2"
54-544-0	8-32	3/4"
54-552-0	10-32	1/2"
54-554-0	10-32	3/4"
54-524-0	4-40	3/4"

Nickel Plated Flat Washers

Part #	Size
54-517-0	#2
54-537-0	#6
54-547-0	#8
54-557-0	#10



Internal Lock Washers

Zinc plated. Add "C" to end of part number for 100 pack.



Part #	Size
10-122	2
10-124	4



External Lock-Washer / Nut

These hex nuts have an external star lock-washer attached. Add "C" to end of part number for 100 pack.



Part #	Size
10-014	4-40
10-016	6-32
10-018	8-32

Knurled Dress Nut

Nickel plated brass and are used on controls, switches, capacitors and tip jacks. Add "C" to end of part number for 100 pack.



Part # 10-135

Lockwasher Solder Lugs

These nuts are nickel plated brass and are used on controls, switches, capacitors, and tip jacks. Add "C" to end of part number for 100 pack.

Part #	Size
10-478	#4 x 7/8"
10-479	#6 x 7/8"
10-480	#8 x 7/8"

Nylon Finish Washers

These washers are used with flathead screws. Add "C" to end of part number for 100 pack.

Part #	Size
10-521	10
10-526	6
10-528	8

Nylon Flat Washers

Add "C" to end of part number for 100 pack.



Part #	Size
10-501	#10 x 3/8"
10-502	#2 x 1/4"
10-504	#4 x 1/4"
10-506	#6 x 5/16"
10-508	#8 x 3/8"

Nylon Hex Nuts

Add "C" to end of part number for 100 pack.



Part #	Size
10-510	10-32 x 3/8"
10-512	2-56 x 3/16"
10-514	4-40 x 1/4"
10-516	6-32 x 1/4"
10-518	8-32 x 1/4"

Rubber Grommets

Add "C" to end of part number for 100 pack.

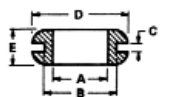

Part #	I.D. "A"	Hole Size "B"	C	D	E
10-046	.125"	.250"	.062"	.343"	.187"
10-047	.187"	.312"	.062"	.437"	.218"
10-048	.250"	.375"	.062"	.562"	.250"
10-049	.500"	.750"	.093"	.968"	.281"



Hardware, Terminals & Tape - Screws, Nuts, Etc.



Snap-in Hole Plugs

Excellent spring retention. They are made of nickel plated steel. They may be used to cover chassis holes, access ports, and wiring outlets. Add "C" to end of part number for 100 pack.



Part #	Hole Diameter	A	B	C
10-025	1/4"	.406"	.234"	.062"
10-026	3/8"	.500"	.234"	.062"
10-027	1/2"	.656"	.281"	.078"
10-028	3/4"	.921"	.296"	.078"

Nylon Machine Screws

Available in a variety of styles and sizes. Made of the highest quality nylon and to the toughest specifications. Add "C" to end of part number for 100 pack.



Part #	Head Type	Size
10-705	Binderhead	10-32 x 1/2"
10-711	Binderhead	10-32 x 1"
10-722	Binderhead	2-56 x 1/4"
10-725	Binderhead	2-56 x 1/2"
10-742	Binderhead	4-40 x 1/4"
10-745	Binderhead	4-40 x 1/2"
10-747	Binderhead	4-40 x 3/4"
10-762	Binderhead	6-32 x 1/4"
10-763	Binderhead	6-32 x 3/8"
10-765	Binderhead	6-32 x 1/2"
10-766	Binderhead	6-32 x 5/8"
10-767	Binderhead	6-32 x 3/4"
10-783	Binderhead	8-32 x 3/8"
10-785	Binderhead	8-32 x 1/2"
10-787	Binderhead	8-32 x 3/4"
10-805	Flathead	10-32 x 1/2"
10-811	Flathead	10-32 x 1"
10-822	Flathead	2-56 x 1/4"
10-825	Flathead	2-56 x 1/2"
10-842	Flathead	4-40 x 1/4"
10-845	Flathead	4-40 x 1/2"
10-847	Flathead	4-40 x 3/4"
10-862	Flathead	6-32 x 1/4"
10-863	Flathead	6-32 x 3/8"
10-865	Flathead	6-32 x 1/2"
10-866	Flathead	6-32 x 5/8"
10-867	Flathead	6-32 x 3/4"
10-883	Flathead	8-32 x 3/8"
10-885	Flathead	8-32 x 1/2"
10-887	Flathead	8-32 x 3/4"
10-905	Round	10-32 x 1/2"
10-911	Round	10-32 x 1"
10-922	Round	2-56 x 1/4"
10-925	Round	2-56 x 1/2"
10-942	Round	4-40 x 1/4"
10-945	Round	4-40 x 1/2"
10-947	Round	4-40 x 3/4"
10-962	Round	6-32 x 1/4"
10-963	Round	6-32 x 3/8"
10-965	Round	6-32 x 1/2"
10-966	Round	6-32 x 5/8"
10-967	Round	6-32 x 3/4"
10-983	Round	8-32 x 3/8"
10-985	Round	8-32 x 1/2"
10-987	Round	8-32 x 3/4"



Switch and Control Mounting Nuts

Add "C" to end of part number for 100 pack.



Part #	Size
10-133	3/8-32 x 1/2 x 3/32"
10-137	15/32-32 x 9/16 x 5/64"

Zinc Plated Flat Washers

Add "C" to end of part number for 100 pack.



Part #	Size No.
10-002	2
10-004	4
10-006	6
10-008	8
10-010	10

Zinc Plated Split Washers

Add "C" to end of part number for 100 pack.



Part #	Size
10-151	10
10-154	4
10-156	6
10-158	8

Steel Machine Screws

All machine screws are zinc plated for protection against corrosion. Add "C" to end of part number for 100 pack.



Part #	Head Type	Size
10-242	Binderhead	4-40 x 1/4"
10-245	Binderhead	4-40 x 1/2"
10-247	Binderhead	4-40 x 3/4"
10-262	Binderhead	6-32 x 1/4"
10-263	Binderhead	6-32 x 3/8"
10-265	Binderhead	6-32 x 1/2"
10-282	Binderhead	8-32 x 1/4"
10-285	Binderhead	8-32 x 1/2"
10-342	Flathead	4-40 x 1/4"
10-343	Flathead	4-40 x 3/8"
10-345	Flathead	4-40 x 1/2"
10-362	Flathead	6-32 x 1/4"
10-365	Flathead	6-32 x 1/2"
10-367	Flathead	6-32 x 3/4"
10-422	Round	2-56 x 1/4"
10-425	Round	2-56 x 1/2"
10-442	Round	4-40 x 1/4"
10-447	Round	4-40 x 3/4"
10-462	Round	6-32 x 1/4"
10-465	Round	6-32 x 1/2"
10-467	Round	6-32 x 3/4"
10-468	Round	6-32 x 1"
10-469	Round	6-32 x 2"
10-482	Round	8-32 x 1/4"
10-485	Round	8-32 x 1/2"
10-487	Round	8-32 x 3/4"
10-488	Round	8-32 x 1"

Hardware, Terminals & Tape - Screws, Nuts, Etc.



Steel Hex Nuts

Zinc plated for protection against the environment. Add "C" to end of part number for 100 pack.



Part #	Size
10-102	2-56
10-104	4-40
10-106	6-32 x 1/4"
10-107	6-32 x 5/16"
10-108	8-32 x 1/4"
10-109	8-32 x 5/16"
10-110	10-32 x 3/8"



Steel Machine Screws

All machine screws are zinc plated for protection against corrosion. Add "C" to end of part number for 100 pack.



Part #	Head Type	Size
10-215	Binderhead	10-32 x 1/2"
10-405	Round	10-32 x 1/2"
10-407	Round	10-32 x 3/4"
10-411	Round	10-32 x 1"

Hardware, Terminals & Tape - Terminals



PAN-TERM® Ring Terminal Non-Insulated

Brazed seam assures a reliable crimp. Internally beveled for easy wire insertion. Extended barrel length helps to simplify the crimp process to assure a good quality termination. Wire range is 12-10 AWG, except P18-12R-C (22-18 AWG) and P14-12R-L (16-14 AWG).



Part #	Stud Size	Length Ins. (mm)	Width inches (mm)
P18-12R-C	1/2	1.20 (30.5)	.72 (18.3)
P14-12R-L	1/2	1.20 (30.5)	.72 (18.3)

PAN-TERM® Ring Terminal Vinyl Insulated - Funnel Entry

Funnel entry speeds wire insertion for faster assembly and lower installed costs. Insulation support provides strain relief of the terminal and helps to prevent wire damage if wire is subject to a bending application. Industry standard color coding to indicate wire range. Brazed seam assures a reliable crimp. Wire range is 12-10 AWG, except for part number PV18-12R-CY (22-18 AWG) and PV14-12R-L (16-14 AWG).



Part #	Stud Size	Length Ins. (mm)	Width - Ins. (mm)
PV18-12R-C	1/2	1.42 (36.1)	.72 (18.3)
PV14-12R-L	1/2	1.42 (36.1)	.72 (18.3)

PAN-TERM® Terminals

Designed and manufactured for fast assembly and long, reliable performance. Funnel entry available on vinyl and nylon insulated terminals - to speed assembly. All are made of electrolytically refined copper to provide the optimum combination of crimp forming properties and low resistance, high conductivity terminations. Applicable sizes meet Mil. Spec. MS25036, MS20659, UL and/or CSA requirements.

Non-Insulated



Part #	Wire Size (AWG)	Stud Size
P10-10R-L	12-10	#10
P10-14R-L	12-10	1/4"
P10-38R-L	12-10	3/8"
P10-56R-L	12-10	5/16"
P10-12R-L	12-10	1/2"



PAN-TERM® Terminals (cont.)

Nylon Ins. - Insulation Grip Sleeve



Part #	Wire Size (AWG)	Stud Size
PN10-10R-L	12-10	#10
PN10-14R-L	12-10	1/4"
PN10-38R-L	12-10	3/8"
PN10-56R-L	12-10	5/16"
PN10-12R-L	12-10	1/2"

Vinyl Ins. - Expanded Insulation (RX)



Part #	Wire Size (AWG)	Stud Size
PV10-10RX-L	12-10	#10
PV10-14RX-L	12-10	1/4"
PV10-38RX-L	12-10	3/8"
PV10-56RX-L	12-10	5/16"

Vinyl Ins. - Funnel Entry (#22-10)



Part #	Wire Size (AWG)	Stud Size
PV10-10R-L	12-10	#10
PV10-14R-L	12-10	1/4"
PV10-38R-L	12-10	3/8"
PV10-56R-L	12-10	5/16"
PV10-12R-L	12-10	1/2"

Nylon Ins. - Expanded Insulation (RX)



Part #	Wire Size (AWG)	Stud Size
PN10-10RX-L	12-10	#10
PN10-14RX-L	12-10	1/4"
PN10-38RX-L	12-10	3/8"
PN10-56RX-L	12-10	5/16"

Hardware, Terminals & Tape - Terminals



Ring Terminal Nylon Insulated

Metal insulation grip sleeve for high vibration or conductor strain applications. Color-coded insulation sleeve identifies wire range by using industry standard colors. Provides quick visual identification of intended range of wires.



Part #	Stud Size	Length inches (mm)	Width inches (mm)
PN18-12R-C	1/2	1.35 (34.3)	.72 (18.3)
PN14-12R-L	1/2	1.35 (34.3)	.72 (18.3)



Piggyback Quick Connects

Add EP to end of part number for econo-packs. For example - 73-338EP.



Part #	Wire Range	Tab Size	CSA/UL
73-338-0	22-16	.250"	UL/CSA
73-348-0	12-10	.250"	UL/CSA

Insulated Female Quick Connects

Add EP to end of part number for econo-packs. For example - 73-331EP.



Part #	Wire Range	Tab Size	Pkg	Dim. B	Dim. L	Dim. L1	CSA/UL
73-331-0	22-16 (red)	.110"	-100	3.1	19.5	15.0	UL
73-333-0	22-16 (red)	.187"	-100	5.6	19.0	14.0	UL
73-336-0	22-16 (red)	.250"	-100	7.4	21.0	14.0	UL/CSA
73-341-0	16-14 (blue)	.110"	-100	3.8	19.0	14.0	UL/CSA
73-343-0	16-14 (blue)	.187"	-100	5.6	19.0	14.0	UL/CSA
73-346-0	16-14 (blue)	.250"	-100	7.4	21.0	16.0	UL/CSA
73-356-0	12-10	.250"	-50	7.4	21.0	16.0	UL/CSA

UNC Hardware Kits

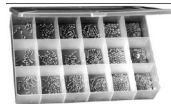

Part #	Description
54-561-1	260 pieces of assorted 2-56 screws, nuts, flat washers and lock washers. Screw lengths are 1/4" and 1/2". In clear polystyrene box with 6 separate compartments.
54-562-1	220 pieces of assorted 4-40 screws, nuts, flat washers and lock washers. Screw lengths are 1/4", 1/2" and 3/4". In clear polystyrene box with 6 separate compartments.
54-563-1	220 pieces of assorted 6-32 screws, nuts, flat washers and lock washers. Screw lengths are 1/4", 3/8", 1/2", 5/8" and 3/4". In a clear polystyrene box with 6 separate compartments.
54-564-1	220 pieces of assorted 8-32 screws, nuts, flat washers and lock washers. Screw lengths provided are 1/4", 3/8", 1/2" and 3/4". In a clear polystyrene box with 6 separate compartments.
54-565-1	1175 pieces of assorted 2-56, 4-40, 6-32 and 8-32 hardware. In a durable 18 compartment polypropylene box (53-918-0).

Insulated Flanged Spade Terminals



Part #	Wire Range	Stud Size	Pkg	Dim. B	Dim. L	Dim. L1
73-233-0	22-16 (red)	#6	-100	9.0	24.0	21.9
73-234-0	22-16 (red)	#8	-100	9.0	24.0	21.9
73-235-0	22-16 (red)	#10	-100	8.5	23.7	18.7
73-243-0	16-14 (blue)	#6	-100	8.5	23.7	18.7
73-244-0	16-14 (blue)	#8	-100	8.5	23.7	8.7
73-245-0	16-14 (blue)	#10	-100	8.5	23.7	18.7
73-255-0	12-10	#10	-50	8.3	25.2	19.0

Insulated Male Quick Connects

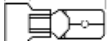

Part #	Wire Range	Tab Size	Pkg	Dim. B	Dim. L	Dim. L1	CSA/UL
73-431-0	22-16 (red)	.110"	-100	2.80	20.0	15.5	-
73-433-0	22-16 (red)	.187"	-100	4.75	20.0	15.0	UL/CSA
73-436-0	22-16 (red)	.250"	-100	6.35	21.0	16.0	UL/CSA
73-441-0	16-14 (blue)	.110"	-100	2.80	20.0	15.5	-
73-443-0	16-14 (blue)	.187"	-100	.75	20.0	15.0	UL/CSA
73-446-0	16-14 (blue)	.250"	-100	6.35	21.0	16.0	-
73-456-0	12-10	.250"	-50	6.35	25.0	18.0	-

Fully Insulated Female Quick Connects



Part #	Wire Range	Tab Size	Pkg	Dim. B	Dim. L	Dim. L1	CSA/UL
73-334-0	22-16	.187"	-50	5.6	20.0	15.0	UL/CSA
73-337-0	22-16	.250"	-50	7.4	21.5	16.5	UL/CSA
73-344-0	16-14	.187"	-50	5.6	20.0	15.0	UL/CSA
73-347-0	16-14	.250"	-50	7.4	21.5	16.5	UL/CSA
73-357-0	12-10	.250"	-50	7.4	25.5	20.5	UL/CSA

Terminal Assortments

Butt Connector Assortment

Contains 25 pieces of each wire size.

Part # 73-006-1



Closed End Connector Assortment

Contains 25 each of all 3 sizes.

Part # 73-008-1



Large Terminal Assortment

Includes 180 pieces of the most popular ring, spade, butt and quick connect terminals in a durable box.

Part # 73-001-1



Wire Nut Assortment

Contains 25 each of gray, blue and orange, 15 red and 10 yellow.

Part # 73-009-1



Hardware, Terminals & Tape - Terminals



Terminal Assortments (cont.)

Wire Tap Assortment

Contains 10 each of 73-760, 73-770 and 6 of 73-780-0.



Part # 73-007-1

Insulated Ring Terminals

Add EP to end of part number for econo-packs. For example - 73-032EP.



Part #	Wire Range	Stud Size	Pkg	Dim. B	Dim. L	Dim. L1	CSA/UL
73-032-0	22-16 (red)	#4	-100	5.7	17.8	12.8	UL
73-033-0	22-16 (red)	#6	-100	5.7	17.8	12.8	UL
73-034-0	22-16 (red)	#8	-100	6.6	20.1	15.1	UL
73-035-0	22-16 (red)	#10	-100	8.0	21.5	16.5	UL
73-036-0	22-16 (red)	1/4"	-100	11.6	27.5	22.5	UL
73-043-0	16-14 (blue)	#6	-100	6.6	17.8	2.8	UL
73-044-0	16-14 (blue)	#8	-100	6.6	18.5	3.5	-
73-045-0	16-14 (blue)	#10	-100	8.5	21.0	16.5	-
73-046-0	16-14 (blue)	1/4"	-50	12.0	27.6	22.6	UL
73-054-0	12-10 (yellow)	#8	-50	7.2	21.4	15.2	UL
73-055-0	12-10 (yellow)	#10	-50	9.5	25.5	19.3	UL
73-056-0	12-10 (yellow)	1/4"	-50	12.0	31.5	25.3	UL

Insulated Spade Terminals

Add EP to end of part number for econo-packs. For example - 73-132EP.



Part #	Wire Range	Stud Size	Pkg	Dim. B	Dim. L	Dim. L1	CSA/UL
73-132-0	22-16 (red)	#4	-100	5.7	21.2	16.2	UL/CSA
73-133-0	22-16 (red)	#6	-100	5.7	21.2	16.2	UL/CSA
73-134-0	22-16 (red)	#8	-100	6.4	21.2	16.2	UL/CSA
73-135-0	22-16 (red)	#10	-100	8.1	21.2	16.2	UL/CSA
73-143-0	16-14 (blue)	#6	-100	5.7	21.2	16.2	CSA
73-144-0	16-14 (blue)	#8	-100	6.4	21.2	16.2	CSA
73-145-0	16-14 (blue)	#8	-100	8.1	21.2	16.2	CSA
73-146-0	16-14 (blue)	1/4"	-100	9.5	21.2	16.2	CSA
73-154-0	12-10 (yellow)	#8	-50	8.3	25.2	9.0	UL/CSA
73-155-0	12-10 (yellow)	#10	-50	9.0	23.9	17.7	UL/CSA
73-156-0	12-10 (yellow)	1/4"	-50	9.0	23.9	17.7	UL/CSA

Wire Tap Splices

These connectors make it easy to splice into an existing cable in order to add another wire. They are available in three different sizes which are insulated and color coded for wire size identification. Add "C" to part number for 100 pack.

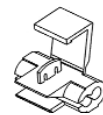

Part #	Wire Range	Color	Package Qty.
65-1280	22 - 18	Red	10
65-1285	16 - 14	Blue	10
65-1290	12 - 10	Yellow	10

Insulated Seamless Butt Connectors

These butt connectors are braised and seamless for a smoother and more uniform crimp. They are available in several wire sizes with color coded insulation. Add "C" to part number for 100 pack.



Part #	Wire Size	Barrel Length (mm)	Material	Color	Package Qty.
65-1230	22 - 16	30.0	Vinyl	Red	10
65-1240	12 - 10	33.0	Vinyl	Yellow	10
65-1830	22 - 16	30.0	Nylon	Red	10
65-1835	16 - 14	30.0	Nylon	Blue	10
65-1840	12 - 10	33.0	Nylon	Yellow	5

Nylon Insulated Close End Connectors

These close end or pigtail connectors are constructed of tin plated copper which has a clear nylon insulator. They are available to accommodate several different wire sizes. Add "C" to part number for 100 pack.



Part #	Wire Range	Package Qty.
65-1232	22 - 14	12
65-1237	18 - 10	5
65-1242	18 - 8	5

Quick Connect Female Terminals

Quick connect terminals are constructed of high quality copper that are tin plated. They are available in both non-insulated and insulated types. Add "C" to part number for 100 pack.



Insulated

Part #	Thick. (in.)	Width (in.)	Color	AWG	Package Qty.
65-4521	.020	.110	Red	22-16	15
65-4524	.020	.187	Red	22-16	15
65-4541	.020	.110	Blue	16-14	15
65-4542	.020	.187	Blue	16-14	15
65-4545	.032	.250	Blue	16-14	12
65-4565	.032	.250	Yellow	12-10	10
65-4568	.048	.375	Yellow	12-10	5
65-4525	.032	.250	Red	22-16	12

Non-Insulated

Part #	Thick. (in.)	Width (in.)	Color	AWG	Package Qty.
65-4021	.020	.110	Red	22-16	15
65-4022	.020	.187	Red	22-16	15
65-4025	.032	.250	Red	22-16	15
65-4041	.020	.110	Blue	16-14	15
65-4042	.020	.187	Blue	16-14	15
65-4045	.032	.250	Blue	16-14	15
65-4065	.032	.250	Yellow	12-10	15
65-4068	.048	.375	Yellow	12-10	10

Hardware, Terminals & Tape - Terminals



Female Bullet Connector Receptacles

These bullet connectors are made of copper with tin plating. They are available in several wire sizes with male plugs to match. They are fully insulated. Thickness is .032. Insulation material is vinyl. Add "C" to part number for 100 pack.



Part #	Wire Size	Width (in.)	Color	Package Qty.
65-6521	22 - 16	.156	Red	8
65-6541	16 - 14	.156	Blue	8
65-6542	16 - 14	.195	Blue	8
65-6562	12 - 10	.195	Yellow	8

Male Bullet Connector Terminals

These bullet connectors are made of copper with tin plating. They are available in several wire sizes with receptacles to match. Insulation material is vinyl. Thickness is .032 inch. Add "C" to part number for 100 pack.

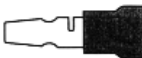

Part #	Wire Size	Width (in.)	Color	Package Qty.
65-7521	22 - 16	.156	Red	12
65-7541	16 - 14	.156	Blue	15
65-7562	12 - 10	.195	Yellow	12

Non-Insulated Seamless Butt Connectors

These butt connectors are braided and seamless for a smoother and more uniform crimp. They are available in several wire sizes. Add "C" to part number for 100 pack.



Part #	Wire Size	Barrel Length (mm)	Package Qty.
65-3020	22 - 16	15.0	10
65-3040	16 - 14	15.0	8
65-3060	12 - 10	20.0	5

12-10 AWG Spade Terminals

Spade terminals are constructed of high quality copper that are tin plated. They are available in both non-insulated and insulated types. Add "C" to part number for 100 pack. Color is yellow.



Insulated

Part #	Stud	Width (mm)	Package Qty.
65-2564	6	8.3	8
65-2565	8	9.0	8
65-2566	10	9.0	8
65-2567	1/4"	12.0	5

Non-Insulated

Part #	Stud	Width (mm)	Package Qty.
65-2064	6	8.3	8
65-2065	8	9.0	8
65-2066	10	9.0	8
65-2067	1/4"	12.0	5



12-10 Ring Terminals

Ring terminals are constructed of high quality copper that are tin plated. They are available in both non-insulated and insulated types. Add "C" to part number for 100 pack. Color is yellow.



Insulated

Part #	Stud	Width (mm)	Package Qty.
65-1563	4	6.6	8
65-1564	6	7.2	8
65-1565	8	9.5	8
65-1566	10	9.5	8
65-1567	1/4"	12.0	5
65-1568	5/16"	15.0	5
65-1569	3/8"	15.0	5

Non-Insulated

Part #	Stud	Width (mm)	Package Qty.
65-1064	6	7.2	10
65-1065	8	9.5	8
65-1066	10	9.5	8
65-1067	1/4"	12.0	5
65-1068	5/16"	15.0	5
65-1069	3/8"	15.0	5

16-14 AWG Ring Terminals

Ring terminals are constructed of high quality copper that are tin plated. They are available in both non-insulated and insulated types. Add "C" to part number for 100 pack. Color is blue.

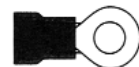

Insulated

Part #	Stud	Width (mm)	Package Qty.
65-1543	4	6.6	12
65-1544	6	6.6	12
65-1545	8	8.5	12
65-1546	10	8.5	12
65-1547	1/4"	12.0	10
65-1548	5/16"	12.0	10

Non-Insulated

Part #	Stud	Width (mm)	Package Qty.
65-1042	8	8.5	12
65-1043	4	6.6	15
65-1044	6	6.6	12
65-1046	10	8.5	12
65-1047	1/4"	12.0	10
65-1048	5/16"	12.0	10

16-14 AWG Spade Terminals

Spade terminals are constructed of high quality copper that are tin plated. They are available in both non insulated and insulated types. Add "C" to part number for 100 pack. Color is blue.



Insulated

Part #	Stud	Width (mm)	Package Qty.
65-2543	4	5.7	12
65-2544	6	5.7	12
65-2545	8	7.2	12
65-2546	10	9.5	12
65-2547	1/4"	12.0	8

Hardware, Terminals & Tape - Terminals



16-14 AWG Spade Terminals (cont.)

Non-Insulated

Part #	Stud	Width (mm)	Package Qty.
65-2043	4	5.7	15
65-2044	6	5.7	15
65-2045	8	7.2	15
65-2046	10	9.5	15
65-2047	1/4"	12.0	8

22-16 AWG Ring Terminals

Ring terminals are constructed of high quality copper that are tin plated. They are available in both non-insulated and insulated types. Add "C" to part number for 100 pack. Color is red.



Insulated

Part #	Stud	Width (mm)	Package Qty.
65-1523	4	5.7	15
65-1524	6	5.7	15
65-1525	8	8.0	15
65-1526	10	8.0	15
65-1527	1/4"	12.0	1
65-1528	5/16"	12.0	1

Non-Insulated

Part #	Stud	Width (mm)	Package Qty.
65-1022	8	8.0	15
65-1023	4	5.7	15
65-1024	6	5.7	15
65-1026	10	8.0	15
65-1027	1/4"	12.0	1
65-1028	5/16"	12.0	1

22-16 AWG Spade Terminals

Ring terminals are constructed of high quality copper that are tin plated. They are available in both non-insulated and insulated types. Add "C" to part number for 100 pack. Color is red.



Insulated

Part #	Stud	Width (mm)	Package Qty.
65-2523	4	5.7	15
65-2524	6	5.7	15
65-2525	8	7.2	15
65-2526	10	9.5	12
65-2527	1/4"	12.0	12

Non-Insulated

Part #	Stud	Width (mm)	Package Qty.
65-2023	4	5.7	15
65-2024	6	5.7	15
65-2025	8	7.2	15
65-2026	10	9.5	15
65-2027	1/4"	12.0	8



12-10 AWG Quick Connect Male Terminals

Quick connect terminals are constructed of high quality copper that are tin plated. They are available in both non-insulated and insulated types. Add "C" to part number for 100 pack. Color is yellow.

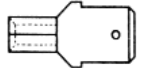

Part #	Thick. (in.)	Width (in.)	Package Qty.
65-5065	.032	.250	15

16-14 AWG Quick Connect Male Terminals

Quick connect terminals are constructed of high quality copper that are tin plated. They are available in both non insulated and insulated types. Add "C" to part number for 100 pack. Color is blue.



Insulated

Part #	Thick. (in.)	Width (in.)	Package Qty.
65-5542	.020	.187	12
65-5545	.032	.250	15
65-5565	.032	.250	15

Non-Insulated

Part #	Thick. (in.)	Width (in.)	Package Qty.
65-5042	.020	.187	15
65-5045	.032	.250	15

22-16 AWG Quick Connect Male Terminals

Quick connect terminals are constructed of high quality copper that are tin plated. They are available in both non-insulated and insulated types. Add "C" to part number for 100 pack. Color is red.

Insulated

Part #	Thick. (in.)	Width (in.)	Package Qty.
65-5521	.020	.110	12
65-5522	.020	.187	12
65-5525	.032	.250	12

Non-Insulated

Part #	Thick. (in.)	Width (in.)	Package Qty.
65-5021	.020	.110	15
65-5022	.020	.187	15
65-5025	.032	.250	15

Fully Insulated Nylon Female Flag Terminals

Add "C" to part number for 100 pack.



Part #	Description	Package Qty.
65-4725	.250 Red 22-16 AWG	5
65-4745	.250" Blue 16-14 AWG	5

Fully Insulated Quick Connect Female Terminals

Add "C" to part number for 100 pack. Insulation material material is vinyl.

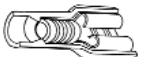

Part #	Wire Size	Thick. (in.)	Width (in.)	Color	Package Qty.
65-4322	22-16	.020	.187	Red	10
65-4325	22-16	.032	.250	Red	5
65-4342	16-14	.020	.187	Blue	10
65-4345	16-14	.032	.250	Blue	5
65-4365	12-10	.032	.250	Yellow	8

Hardware, Terminals & Tape - Terminals



Female Flag Terminals

Butted Seam - Non Insulated

22-16. .030 Stock

Part #	Description
2375N	.250 Width

16-14. .030 Stock

Part #	Description
2475N	.250 Width

Universal Nylon Housings For GM Terminals

Part #	Description
156	1 Cavity. Shroud for male terminals, mates with 157. Use with 150 or 153.
157	1 Cavity. Shroud for male terminals, mates with 156. Use with 150 or 153.
158	2 Cavity. Shroud for male terminal, mates with 156. Use with 150 or 153.
159	2 Cavity. Tower for female terminal, mates with 158. Use with 151 or 154.
160	3 Cavity. Shroud for male terminals, mates with 161. Use with 150 or 153.
161	3 Cavity. Tower for female terminals, mates with 160. Use with 151 or 154.
176	4 Cavity. Shroud for male terminal, mates with 177. Use with 150 or 153.
177	4 Cavity. Tower for female terminal, mates with 176. Use with 151 or 154.
190	4 Cavity. Square shroud for male terminals, mates with 191. Use with 151 or 154.
191	4 Cavity. Square tower for female terminals, mates with 190. Use with 151 or 154.
192	5 Cavity. Round shroud for male terminals, mates with 193. Use with 151 or 154.
193	5 Cavity. Round tower for female terminals, mates with 192. Use with 151 or 154.
178	6 Cavity. Shroud for male terminal, mates with 179. Use with 150 or 153.
179	6 Cavity. Tower for female terminal, mates with 178. Use with 151.

Tubular Lug Rings

Solid copper tubular stock electro-tin plated solder or crimp type used for heavy duty wiring. Rated for 600 Volts. Change suffix PK to C for 100 packs.

Part #	Wire AWG	Size
4035	8	#10
4036	8	1/4"
4038	8	5/16"
4039	8	3/8"
4043	8	1/2"
4135	6	#10
4136	6	1/4"
4138	6	5/16"
4139	6	3/8"
4143	6	1/2"
4235	4	#10
4236	4	1/4"
4238	4	5/16"
4239	4	3/8"
4243	4	1/2"
4336	2	1/4"
4338	2	5/16"
4339	2	3/8"

Tubular Lug Rings (cont.)

Part #	Wire AWG	Size
4843	1	1/2"
4438	1/0	5/16"
4439	1/0	3/8"
4443	1/0	1/2"
4538	2/0	5/16"
4539	2/0	3/8"
4543	2/0	1/2"
4639	3/0	3/8"
4643	3/0	1/2"
4739	4/0	3/8"
4743	4/0	1/2"

Modular Terminals

Terminals are silver plated copper. Connectors offer optimal conductivity. Contacts have flared barrel openings for easy wire entry.

175 Amp Series

Part #	Gauge	A	B	C	D	E
3254	4	2.35"	0.51"	0.30"	1.04"	0.50"
3255	2	2.35"	0.51"	0.35"	1.04"	0.50"
3256	1/0	2.35"	0.51"	0.44"	1.04"	0.50"

Modular Housing

Available in several different colors to avoid mating of different voltages. Impact and vibration resistance. Made of polycarbonate.

175 Amp Series

Fits Gauge: 4, 2, 1/0. A: 2.18", B: 3.13", C: 1.09", D: 1.00".

Part #	Color
3270	Blue
3271	Red
3272	Yellow
3274	Grey

WeatherPack Connectors

GM Weather Pack Series. The Weather Pack system consists of mating housings (towers and shrouds), male or female weather pack terminals, & weather pack cable seals.

Part #	Description
150	20-18 GA Tin-Plated Brass Male, mates with 151
151	20-18 GA Tin Plated Brass female, mates with 150
152	20-18 GA Silicone Cable Seal green cable dia-2.8502.03mm. Use with 150&151
153	16-14 GA Tin Plated Brass Male, mates with 154
154	16-14 Silicone cable seal, grey cable dia 3.49-2.81mm. Use with 153&154
180	Silicone cable seal red cable dia-1.70-1.29mm
162	16-14 GA Silicone cable seal, grey cable dia 3.49-2.81mm. Use with 153&154
155	Silicone cavity plug, used to plug empty cavities in connector shell.
197	12 GA Tin plated brass male, mates with 198
198	12 GA Tin plated brass female, mates with 197
199	12 GA Silicone cable seal blue cable dia 4.30-3.45mm. Use with 197&198

Hardware, Terminals & Tape - Terminals



Butt Connectors

Butt Splice involving two crimps, one over each wire. Insulated connectors provide insulation from wire to wire.



Vinyl Flared Insulated-Butted Seam

Part #	Description
1800	16-14 .030 Stock
1900	12-10 .040 Stock
1700	22-16 .030 Stock

Butted Seam-Non Insulated

Part #	Description
2300	22-16 .030 Stock
2400	16-14 .030 Stock
2500	12-10 .040 Stock

Female & Male Quick Connects

A quick connect is composed of two parts, receptacle (female part) and mating tab (male part). The terminals are designed to function as a complete unit or for use on fuse blocks.



Vinyl Flared Insulated Butted Seam

Part #	Type	Description	Width
1749	22-16	Female	.110
1750	22-16	Male	.110
1751	22-16	Female	.187
1752	22-16	Male	.187
1755	22-16	Female	.250
1756	22-16	Male	.250
1851	16-14	Female	.187
1855	16-14	Female	.250
1856	16-14	Male	.250
1849	16-14	Female	.110
1955	12-10	Female	.250
1956	12-10	Male	.250
1850	16-14	Male	.110
1852	16-14	Male	.187
1853	16-14	Female	.205

Non Insulated Butted Seam

Part #	Type	Description	Width
2349	22-16	Female	.110
2449	16-14	Female	.110
2451	16-14	Female	.187
2453	16-14	Female	.205
2455	16-14	Female	.250
2355	22-16	Female	.250
2555	12-10	Female	.250

Vinyl Female and Male Quick Connects

Fully insulated.

Part #	Type	Description	Width
1865	16-14	Female	.250
1864	16-14	Male	.250
1965	12-10	Female	.250
1964	12-10	Male	.250
1765	22-16	Female	.250
1764	22-16	Male	.250



Closed End Connectors

Nylon insulated close-end wire connectors. To apply, insert pre-stripped wires into connector tube and crimp it with crimping tool to hold wires firmly even in vibration. Material: UL approved nylon 66, 94V-2. Temperature rating: 105c (221f) max. 300v max. Available in mini packs, 50 pieces, 100 pieces and 1000 pieces.



Part #	Gauge
1166	22-16
1266	16-14
1366	12-10
4066	8

Tap In-Connectors

Makes tap-in line or pigtail connections without cutting or stripping. Insert hot line and tap-in, compress metal clip, close cover. Available in mini-packs, 15 pieces or 100 pieces.

Part #	Gauge	Color
1558	22-18	Red
1560	18-14	Blue
1565	18-14	Blue gel filled weatherproof

Rings

Ring Connectors Non-Insulated

Butted Seam-Non Insulated. 12-10. .040 Stock.

Part #	Description
2504	Stud Size #8
2505	Stud Size #10
2506	Stud Size 1/4"
2508	Stud Size 5/16"
2509	Stud Size 3/8"
2513	Stud Size 1/2"

Vinyl Flared Insulated - Butted Seam. 16-14. .030 Stock.

Part #	Type	Stud Size
1805	16-14	#10
1804	16-14	#8
1806	16-14	1/4"
1808	16-14	5/16"
1809	16-14	3/8"
1803	16-14	#6

Butted Seam-Non Insulated. 16-14. .030 Stock

Part #	Description
2403	Stud Size # 6
2404	Stud Size # 8
2405	Stud Size # 10
2406	Stud Size 1/4"
2408	Stud Size 5/16"
2409	Stud Size 3/8"

Vinyl Flared Insulated-Butted Seam. 22-18. .030 Stock.

Part #	Description
1704	Stud Size # 8
1705	Stud Size # 10
1702	Stud Size # 4
1703	Stud Size # 6
1706	Stud Size 1/4"
1708	Stud Size 5/16"
1709	Stud Size 3/8"



Hardware, Terminals & Tape - Terminals



Rings (cont.)

Vinyl Flared Insulated-Butted Seam. 12-10. .040 Stock.

Part #	Description
1905	Stud Size # 10
1903	Stud Size # 6
1904	Stud Size # 8
1906	Stud Size 1/4"
1908	Stud Size 5/16"
1909	3/8"
1913	Stud Size 1/2"

Silicone cable seals

Use with #153 and #154 OEM # 12010293

Part #	Description
162	16-14 Ga

Spades

Vinyl Flared Insulated Butted Seam. Available in a narrow configuration - ie 1823*

16-14. .030 Stock

Part #	Description
1823	*Stud Size # 6
1824	*Stud Size # 8
1825	Stud Size # 10

22-18 .030 Stock

Part #	Description
1723	*Stud Size # 6
1724	*Stud Size # 8
1725	Stud Size #10

12-10 .040 Stock

Vinylflared Insulated - Butted Seam

Part #	Description
1923	Stud Size #6
1924	Stud Size #8
1925	Stud Size #10

Rings

Butted Seam-Non Insulated. 22-16. .030 Stock

Part #	Description
2303	Stud Size # 6
2304	Stud Size # 8
2305	Stud Size # 10
2306	Stud Size 1/4"
2308	Stud Size 5/16"
2309	Stud Size 3/8"

Piggy Back Disconnects-Vinyl

Pin Connectors-Vinyl

Part #	Description
1869	16-14 .030 Stock
1960	12-10 .040 Stock
1760	22-18 .030 Stock

Wire Connectors

Five color coded models cover common construction wire ranges. Ribbed cpa provides positive grip for fast easy installation. Narrow design allows more room in tight boxes. Deep, wide throated skirt protects against flashover and turned back strands. Fixes square spring. Provides more secure gripping on conductors.

Change suffix CS to M for 1000 pack. Show in Mini Pack.

Part #	50 Pcs	100 Pcs	Voltage	Color	Wire Combo Range
1601-BP	1601-15	1601-CS	300	Grey	Min 2 #22 - Max 2 # 16
1602-BP	1602-15	1602-CS	300	Blue	Min 2 #18 - Max 3 # v16
1603-BP	1603-15	1603-36	600	Orange	Min 2 #18 - Max 2 # v14
1604-BP	1604-15	1604-36	600	Yellow	Min 3 #v18 - Max 4 #v14 and 1 #18
1605-BP	1605-15	1605-36	600	Red	Min 2 #14 - Max 4 #12

600v maximum building wire. 1000v maximum in fixtures and signs.

Temperature rating: 105°C (221°F). Change suffix 36 to 39 for 1000 pack.

Shown in Mini Pack.

Part #	10 Pcs	100 Pcs	Gauge	Color	Wire Combo Range
1620-13	1620-14	1620-36	18-10	Yellow	Min 2 #8 - Max 3 #12
1621-13	1621-14	1621-36	18-10	Red	Min 2 #14 - Max 4 #12
1622-13	1622-14	1622-36	12-6	Blue	Min 3 #12 - Max 1 #6 and 2 #8



.062" Pin and Socket Terminals

Available in gold and tin platings. Available in Brass or Phosphor Bronze materials. Accommodates 18 to 30 gauge wire.

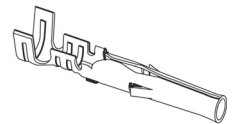

Female Terminals

Part #	Type	Plating	Crimp Wire Size	Insulation Diameter
02-06-1101	Standard brass .008"	Tin	18/24	1.52/3.05 (.060/.120)
02-06-1131	Standard brass .008"	Tin	24-30	1.02/2.29 (.040/.090)

Male Terminals

Part #	Type	Plating	Crimp Wire Size	Insulation Diameter
02-06-2101	Standard brass .008"	Tin	18-24	1.52/3.05 (.060/.120)
02-06-2131	Standard brass .008"	Tin	24-30	1.02/2.29 (.040/.090)

Hardware, Terminals & Tape - Terminals



.093" Pin and Socket

Available in tin or gold platings. Available in Brass or Phosphor Bronze materials. Accommodates 14 to 30 gauge wire. Available in crimp or PC tail versions

Female Terminals

Part #	Type	Plating	Crimp Wire Size	Insulation Diameter
02-09-1102	Standard brass .010"	Tin	14-20	1.65/4.06 (.065/.160)

Male Terminals

Part #	Type	Plating	Crimp Wire Size	Insulation Diameter
02-09-2116	Standard brass .010"	Tin	18-22	1.52/3.05 (.060/.120)

5556/5558 Series Terminals

Part #	Part No. 5556 Female	Form	AWG Wire Size
39-00-0040	39-00-0038	Chain	18-24
39-00-0041	39-00-0039	Loose	18-24

Pin Terminals For Nylon Housings

Spring tempered tin-plated brass, .093" dia., types fit standard housings: Std. pkg., 100. Style C is for crimp, PC is for printed circuit.

Part #	Female	Style	For Wire Size
02-09-2118	02-09-1118	C	18-24
02-09-2143	02-09-1143	C	22-30
02-09-2134C	02-09-1134C	PC
02-06-2103	02-06-1103	C	18-22



Mini-Fit, Jr. Series Terminal Accessories

Can handle standard equipment I/O currents despite its small size. Positive lock. Audible "clicks" confirm correct contact insertion and correct mating of housing. Voltage rating is 250 V. UL recognized, CSA certified, TUV licensed. Width is 0.378" (9.60).

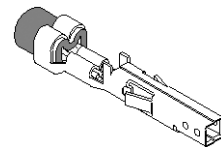

Part #	Type	Wire AWG Range	Insulation Range (inch)	Contact Plating
39-00-0038	Female	18-24	.051 - .122	Brass (tin plated)
39-00-0046	Female	22-28	.035 - .071	Brass (tin plated)

KK® Crimp Terminal

Double cantilever design. Single beam terminal is available for low insertion force 7821 Series. For low-level current and voltage use gold plating. Phosphor Bronze is recommended for rated current. Complete line of terminal crimping equipment.



Part #	Type	Wire Size AWG	Insulation OD	Material
08-50-0105	Tin plating	18-20	2.79 (.110) max.	Brass
08-50-0107	Tin plating	22-26	1.65 (.065) max.	Brass
08-50-0133	Tin plating	22-26	1.65 (.065) max.	Phosphor Bronze
08-52-0072	Tin plating	18-20	2.79 (.110) max.	Phosphor Bronze
08-56-0105	Gold plating	18-20	2.79 (.110) max.	Brass

Hardware, Terminals & Tape - Ferrules



Twin-Wire Ferrules for Two Wires

Material surface is copper/plastic. Surface is tin plated. Dimensions are in mm.

Part #	Size (mm ²)	AWG	Color	Pieces Per Bag	Dim. L-1	Dim. L-2	Dim. D-1	Dim. S-1
13101010	2 x 1.00	2 x 18	Red	500	17.0	10.0	2.05	0.15
13101025	2 x 2.50	2 x 14	Blue	500	18.5	10.0	2.9	0.20
13101075	2 x 0.75	2 x 20	Gray	500	17.0	10.0	1.8	0.15
13121015	2 x 1.50	2 x 16	Black	500	20.0	12.0	2.3	0.15
13121040	2 x 4.00	2 x 12	Gray	100	23.0	12.0	3.8	0.20
13131025	2 x 2.50	2 x 14	Blue	500	21.5	13.0	2.9	0.20
13141060	2 x 6.00	2 x 10	Yellow	100	25.0	14.0	4.9	0.20
13141100	2 x 10.0	2 x 8	Red	100	26.0	14.0	6.5	0.20
13161160	2 x 16.0	2 x 6	Green	50	31.0	16.0	8.5	0.20
1381010	2 x 1.00	2 x 18	Red	500	15.0	8.0	2.05	0.15
1381015	2 x 1.50	2 x 16	Black	500	16.0	8.0	2.3	0.15
1381050	2 x 0.50	2 x 20	White	500	15.0	8.0	1.5	0.15
1381075	2 x 0.75	2 x 20	Gray	500	15.0	8.00	1.8	0.15



Hardware, Terminals & Tape - Ferrules



Wire Ferrules Insulated DIN 46228 Part 4

Material is copper/plastic. Surface is tin plated. *Does not conform to DIN 46228 Part 4. Dimensions in mm.

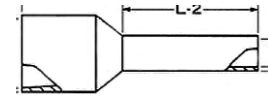

Part #	Size (mm ²)	AWG	Color	Pieces Per Bag	Dim. L-1	Dim. L-2	Dim. D-1	Dim. S-1
11101010	1.00	18	Red	500	16.5	10	1.5	0.15
11101015	1.50	16	Black	500	16.5	10	1.8	0.15
11101040	4.00	12	Gray	500	17.5	10	2.9	0.2
11101050	0.50	20 to 22	White	500	15.5	10	1.1	0.15
11101075	0.75	18 to 20	Gray	500	16.0	10	1.3	0.15
11121010	1.00	18	Red	500	18.5	12	1.5	0.15
11121015	1.50	16	Black	50	18.5	12	1.8	0.15
11121025	2.50	14	Blue	500	19.0	12	2.3	0.15
11121040	4.00	12	Gray	500	20.0	12	2.9	0.2
11121060	6.00	10	Yellow	100	20.0	12	3.6	0.2
11121075	0.75	18 to 20	Gray	500	18.0	12	1.3	0.15
11121100	10.00	8	Red	100	21.0	12	4.6	0.2
11121160	16.00	6	Blue	100	23.0	12	6.0	0.2
11161250	25.00	4	Yellow	50	29.0	16	7.5	0.2
11161350	35.00	2	Red	50	30.0	16	8.5	0.2
11181015	1.50	16	Black	500	24.5	18	1.8	0.15
11181025	2.50	14	Blue	500	25.0	18	2.3	0.15
11181040	4.00	12	Gray	100	26.0	18	2.9	0.2
11181060	6.00	10	Yellow	100	25.0	18	3.6	0.2
11181100	10.00	8	Red	100	27.0	18	4.6	0.2
11181160	16.00	6	Blue	100	29.0	18	6.0	0.2
11181250	25.00	4	Yellow	50	31.0	18	7.5	0.2
11181350	35.00	2	Red	50	32.0	18	8.5	0.2
11201500	50.00	1	Blue	50	36.0	20	10.5	0.35
11201700	70.00*	1/0	Yellow	25	37.0	20	12.7	0.35
11221250	25.00	4	Yellow	50	35.0	22	7.5	0.2
11251350	35.00	2	Red	50	39.0	25	8.5	0.2
11251500	50.00	1	Blue	25	41.0	25	10.5	0.35
11251950	95.00*	3/0	Red	25	44.0	25	14.7	0.35
112711200	120.00*	4/0	Blue	25	48.0	27	16.7	0.45
11271700	70.00*	2/0	Yellow	25	43.0	27	12.7	0.35
113211500	150.00*	300	Yellow	25	58.0	32	19.5	0.5
11610025	0.25*	24 to 26	Yellow	500	10.5	6	0.8	0.25
1161010	1.00	18	Red	500	12.5	6	1.5	0.15
1161014	0.14*	26 to 28	Gray	500	10.5	6	0.8	0.25
1161015	1.50*	16	Black	500	12.5	6	1.8	0.15
1161034	0.34*	22 to 24	Turquoise	500	10.5	6	0.8	0.25
1161050	0.50	20 to 22	White	500	11.5	6	1.1	0.15
1161075	0.75	18 to 20	Gray	500	12.0	6	1.3	0.15
11810025	0.25*	24 to 26	Yellow	500	12.5	8	0.8	0.25
1181010	1.00	18	Red	500	14.5	8	1.5	0.15
1181014	0.14*	26 to 28	Gray	500	12.5	8	0.8	0.25
1181015	1.50	16	Black	500	14.5	8	1.8	0.15
1181025	2.50	14	Blue	500	15.0	8	2.3	0.15
1181034	0.34*	22 to 24	Turquoise	500	12.5	8	0.8	0.25
1181050	0.50	20 to 22	White	500	13.5	8	1.1	0.15
1181075	0.75	18 to 20	Gray	500	14.0	8	1.3	0.15
1181208	2.08*	14	Yellow	500	14.5	8	2.05	0.15

Hardware, Terminals & Tape - Ferrules



Wire Ferrules Non-Insulated DIN 46228 Part 1

Material is copper. Surface is tin plated. Dimensions are in mm. *Does not conform to DIN 46228 Part 1.

Part #	Size (mm ²)	AWG	Pieces Per Bag	Dim. L	Dim. D-1	Dim. D-2	Dim. S
121010050	0.50	20 to 22	1000	10	1.0	2.1	0.15
121010075	0.75	18 to 20	1000	10	1.2	2.3	0.15
121010100	1.00	18	1000	10	1.4	2.5	0.15
121010150	1.50	16	1000	10	1.7	2.8	0.15
121010250	2.50	14	1000	10	2.2	3.4	0.15
121010600	6.00	10	1000	10	3.5	4.7	0.2
121210075	0.75	18 to 20	1000	12	1.2	2.3	0.15
121210100	1.00*	18	1000	12	1.4	2.5	0.15
121210150	1.50	16	1000	12	1.7	2.8	0.15
121210250	2.50	14	1000	12	2.2	3.4	0.15
121210400	4.00	12	1000	12	2.8	4.0	0.2
121210600	6.00	10	1000	12	3.5	4.7	0.2
1212110	10.00	8	500	12	4.5	5.8	0.2
1212116	16.00	6	250	12	5.8	7.5	0.2
1212125	25.00*	4	100	12	7.3	9.5	0.2
121510150	1.50*	16	1000	15	1.7	2.8	0.15
121510250	2.50*	14	1000	15	2.2	3.4	0.15
121510400	4.00	12	000	15	2.8	4.0	0.2
121510600	6.00	10	1000	15	3.5	4.7	0.2
1215110	10.00	8	500	15	4.5	5.8	0.2
1215116	16.00	6	250	15	5.8	7.5	0.2
1215125	25.00	4	100	15	7.3	9.5	0.2
121810150	1.50	16	1000	18	1.7	2.8	0.15
121810250	2.50	14	1000	18	2.2	3.4	0.15
121810400	4.00	12	1000	18	2.8	.0	0.2
121810600	6.00	10	1000	18	3.5	4.7	0.2
1218110	10.00	8	500	18	4.5	5.8	0.2
1218116	16.00	6	250	18	5.8	7.5	0.2
1218125	25.00	4	100	18	7.3	9.5	0.2
1218135	35.00	2	100	18	8.3	11	0.2
1218150	50.00	1	100	18	10.3	13	0.3
122010150	1.50*	16	1000	20	1.7	2.8	0.15
122010250	2.50*	14	1000	20	2.2	3.4	0.15
122010400	4.00*	12	1000	20	2.8	4.0	0.2
122010600	6.00*	10	1000	20	3.5	4.7	0.2
1220110	10.00*	8	500	20	4.5	5.8	0.2
1220116	16.00*	6	250	20	5.8	7.5	0.2
1220135	35.00*	2	100	20	8.3	11	0.2
1222150	50.00*	1	100	22	10.3	13	0.3
1225110	10.00*	8	500	25	4.5	5.8	0.2
1225116	16.00	6	250	25	5.8	7.5	0.2
1225125	25.00	4	100	25	7.3	9.5	0.2
1225135	35.00	2	100	25	8.3	11	0.2
1232116	16.00	6	250	32	5.8	7.5	0.2
1232125	25.00	4	100	32	7.3	9.5	0.2
1232135	35.00	2	100	32	8.3	11	0.2
1232150	50.00	1	100	32	10.3	13	0.3
1232170	70.00*	2/0	100	32	12.5	15	0.4
1232195	95.0*	3/0	100	32	14.5	17	0.4
123811500	150.0*	MCM	100	38	18.5	21	0.5
12401120	120.0*	4/0	100	40	16.5	19	0.5
124011850	185.0*	MCM	100	40	20	23.5	0.6

Wire Ferrules Non-Insulated DIN 46228 Part 1

(cont.)

Part #	Size (mm ²)	AWG	Pieces Per Bag	Dim. L	Dim. D-1	Dim. D-2	Dim. S
12510025	0.25*	24 to 26	1000	5	0.8	1.7	0.15
12510034	0.34*	22 to 24	1000	5	0.9	1.8	0.15
12610050	0.50	20 to 22	1000	6	1.0	2.1	0.15
12610075	0.75	18 to 20	1000	6	1.2	2.3	0.15
12610100	1.00	18	1000	6	1.4	2.5	0.15
12710025	0.25*	24 to 26	1000	7	0.8	1.7	0.154
12710034	0.34*	22 to 24	1000	7	0.9	1.8	0.15
12710150	1.50	16	1000	7	1.7	2.8	0.15
12710250	2.50	14	1000	7	2.2	3.4	0.15
12810050	0.50*	20 to 22	1000	8	1.0	2.1	0.15
12810075	0.75*	18 to 20	1000	8	1.2	2.3	0.15
12810100	1.00*	18	1000	8	1.4	2.5	0.15
12910400	4.00	12	1000	9	2.8	4.0	0.2

Need Help?



If you would like assistance in determining which products are correct for your application, our sales representatives will gladly assist you.

Hardware, Terminals & Tape - Connector Housings



Connector Housings

Dual Row Crimp Connector Housings 70450 Series

Stackable side-by-side and end-to-end on a .100" grid.

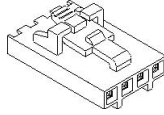

Part #	Circuits
22-55-2041	04
22-55-2061	06
22-55-2081	08
22-55-2101	10
22-55-2121	12
22-55-2161	16
22-55-2181	18
22-55-2201	20
22-55-2221	22
22-55-2261	26
22-55-2281	28
22-55-2321	32
22-55-2401	40
22-55-2441	44
22-55-2461	46
22-55-2501	50
22-55-2541	54
22-55-2141	14

Single Row 70066 Series Version "A"

A non-polarized, and stackable end-to-end or side-by-side. Circuit sizes are 2-25.

Part #	Circuits
50-57-9002	02
50-57-9003	03
50-57-9004	04
50-57-9005	05
50-57-9006	06
50-57-9007	07
50-57-9008	08
50-57-9010	10
50-57-9011	11
50-57-9013	13
50-57-9014	14
50-57-9015	15
50-57-9016	16
50-57-9017	17
50-57-9020	20
50-57-9022	22

Single Row 70066 Series Version "C"

End to end stackable. Available with circuit sizes 2-25.

Part #	Circuits
50-57-9202	02
50-57-9203	03
50-57-9204	04
50-57-9205	05
50-57-9206	06
50-57-9207	07
50-57-9208	08
50-57-9209	09



Connector Housings (cont.)

Single Row 70066 Series Version "G"

Part #	Circuits
50-57-9402	02
50-57-9403	03
50-57-9404	04
50-57-9405	05
50-57-9406	06
50-57-9408	08
50-57-9409	09
50-57-9411	11
50-57-9412	12
50-57-9413	13
50-57-9414	14
50-57-9416	16
50-57-9417	17
50-57-9418	18
50-57-9419	19
50-57-9420	20
50-57-9421	21
50-57-9423	23
50-57-9424	24

Nylon Cable Housing

Highly reliable, versatile connectors rated 250 volts per circuit. Nylon housings are available in miniature size for .062" pin terminals, or standard size for .093" pin terminals (supplied less terminals). Ideal for use in business machines, appliances, communications, instrumentation, and other demanding applications. Available with integrally molded ears for easy panel mounting. All type (except single circuit) are polarized. Both male and female pin terminals of the same mating diameters can be extracted and easily replaced using ejector tools. Housings are UL recognized. *With integrally molded mounting ears. +Holding tabs only. Dimensions in inches.

Standard Nylon Plug Housings

Accepts .093" terminals.

Part #	No. of Circuits	Amps Per Circuit
03-09-2011	1	12
03-09-2021	2	12*
03-09-2022	2	12
03-09-2031	3	12*
03-09-2032	3	12
03-09-2052	5	9
03-09-2061	6	9*
03-09-2062	6	9
03-09-2091	9	9*
03-09-2092	9	9
03-09-2121	12	7.5
03-09-2122	12	7.5*
03-09-2152	15	7.5*

Hardware, Terminals & Tape - Connector Housings



Nylon Cable Housing (cont.)

Miniature Nylon Plug Housings

Accept .062" pin terminals.

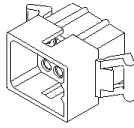

Part #	No. of Circuits	Amps per Circuit
03-06-2011	1	5
03-06-2032	3	5
03-06-2033	3	5*
03-06-2041	4	5*
03-06-2042	4	5
03-06-2054	5	5*
03-06-2055	5	5
03-06-2061	6	5
03-06-2062	6	5*
03-06-2091	9	5*
03-06-2092	9	5
03-06-2121	12	5*
03-06-2122	12	5
03-06-2151	15	5*
03-06-2152	15	5
03-06-2241	24	4*
03-06-2242	24	4
03-06-2362	36	4

Miniature Nylon Receptacle Housings

Part #	No. of Circuits	Amps per Circuit
03-06-1011	1	5+
03-06-1031	3	5
03-06-1032	3	5+
03-06-1041	4	5
03-06-1055	5	5
03-06-1061	6	5
03-06-1091	9	5
03-06-1092	9	5+
03-06-1121	12	5
03-06-1122	12	5+
03-06-1151	15	5
03-06-1152	15	5+
03-06-1241	24	5
03-06-1242	24	5+
03-06-1361	36	4

Standard Nylon Receptacle Housing

Accept .093" terminals. With holding tabs and mounting ears.

Part #	No. of Circuits	Amps per Circuit
03-09-1011	1	12+
03-09-1022	2	12
03-09-1027	2	12
03-09-1031	3	12
03-09-1032	3	12
03-09-1041	4	9
03-09-1052	5	9+
03-09-1061	6	9
03-09-1091	9	9
03-09-1121	12	7.5
03-09-1151	15	7.5



Micro-Fit 3.0 mm (0.118") Rugged Signal Connector System

The Micro-Fit 3.0" is a unique interconnect system designed to meet the needs for a rugged signal connector and incorporates many of the features previously found only on large power connectors. Female connectors and a wire AWG of 20-24.

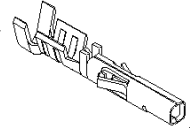

Part #	Plating
43030-0003	Gold
43030-0007	Tin
43030-0009	Gold



Pin and Socket Connectors .093"

Same as the 0.062" series except holds .093" crimp terminals. Molded of natural nylon rated UL94V-2. For bulk; must order pins separately. For packaged; pins supplied with housing. Operating voltage 250V, 12A max. Free hanging plugs with two circuits.

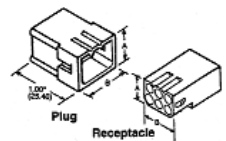

Part # 61-202

Pin and Socket Connectors .062"

These UL approved housings are rated UL94V-2 and hold .062" (1.57mm) crimp terminals. Operating voltage 250V, 5A max. Color is natural.

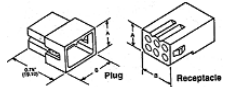

Part #	Type	Circuits
61-102	Free Hanging Plugs	2
61-103	Free Hanging Plugs	3
61-141	Free Hanging Receptacles	1
61-142	Free Hanging Receptacles	2
61-144	Free Hanging Receptacles	4
61-163	Panel Mounting Receptacles w/Mtg. Ears	3



IDC Socket Connectors - .100" Spacing

Part #	Description
206818	10-Pin
206826	20-Pin
206834	26-Pin
206842	34-Pin
32694	40-Pin
32731	50-Pin

Hardware, Terminals & Tape - Terminal Blocks & Accessories

Waldom

ELECTRONICS

Solder Terminals

Optional terminals for use with barrier blocks.

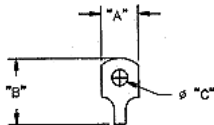

Part #	For Use With
3/4W-140	140/540
Y-140	140/540
Y-141	141/541
Y-142	142/542

Marker Strips

Marker strips identify terminal positions on barrier terminal blocks and insulate exposed portions of terminals from a conductive mounting surface. Marker strips for Series 140 are 1/32" thick, flame-retardant material and mount under the terminal strip. Ordering information: X = available terminals. Ordering example - MS-4-140 or MS-2-141.



Part #	Series	Available Terminals
MS-(X)-140	140	4, 6, 8, 10, 12, 14, 16, 20
MS-(X)-141	141	2, 4, 5, 6, 8, 10, 12, 20

Barrier Terminal Block

Interposing barriers between each terminal position yields substantially higher electrical ratings and provides an additional safeguard against shorting from frayed wires. The wide size range of "Jones" barrier terminal blocks, plus the several termination options and the available accessories permit flexibility of end use applications. The 500 Series Jones barrier terminal blocks have high barriers and are designed for application where especially critical. Bottoms are closed so insulating strips are not required. UL Recognized.

Series 140

With binding head screw, for up to #16 solid wire. Maximum volts RMS with marker strip is 2000 and without marker strip is 1100. Maximum current in amps is 15. Maximum watts per terminal is 3750. X = terminals. Available terminals: 02, 03, 04, 05, 06, 07, 08, 09, 10, 12, 14, 15, 16, 18, 20, 24, 25. Ordering example: 2-140.



Part # (X)-140

Series 141

With binding head screw, for up to #14 solid wire. Maximum volts RMS without marker strip is 1100. Maximum volts RMS with marker strip is 2400. Maximum current in amps is 20. Maximum watts per terminal 5000. X = terminals. Available terminals: 02, 03, 04, 05, 06, 07, 08, 10, 12, 14, 15, 16, 18, 20. Ordering example: 2-141.



Part # (X)-141

Series 142

Accommodates up to #10 solid wire. Maximum volts RMS without marker strips is 1600. Maximum volts RMS with marker strip is 2600. Maximum current in amp is 20. Maximum watts per terminal is 7500. X = terminals. Available terminals: 02, 03, 04, 05, 06, 07, 08, 09, 10, 12, 14, 15, 18. Ordering example: 2-142.



Part # (X)-142

Jumpers

For making connection between adjacent terminals. Model 142J-1 connects two alternative terminals. All jumpers are brass with a nickel-plated finish.



Part #	For Use With
141-J	141
142J-2	142/542



89-200 Series Terminal Strips

30A/600V UL listed, CSA certified (Maximum electrical rating 30A/250V when used with optional quick-connects). .562 inch (14.28mm) center spacing. Accepts wire sizes from 22 through 10 AWG Cu. #8-32 phislot, zinc-plated steel terminal screws.



Part #	Number of Poles
89-202	2
89-203	3
89-204	4
89-206	6
89-208	8
89-210	10
89-212	12

89-300 Series Terminal Strips

15A/250V UL listed, CSA certified (Maximum electrical rating 15A/125V when used with optional quick-connects). .375 inch (9.52mm) center spacing. Accepts wire sizes from 22 through 14 AWG Cu. #6-32 phislot, zinc-plated steel terminal screws.



Part #	Number of Poles
89-302	2
89-304	4
89-308	8
89-310	10
89-312	12

89-500 Series Terminal Strips

60A/600V UL listed, CSA certified (Maximum electrical rating 60A/600V achieved only when used with #6 AWG copper wire crimped to ring terminal). .625 inch (15.88mm) center spacing. Accepts wire sizes from 22 through 6 AWG Cu. #10-32 slotted, nickel-plated brass terminal screws. Standard block style.

Part #	Number of Poles
89-504	4
89-506	6
89-508	8
89-512	12

Barrier Strips

Recessed screws and tubular contacts provide added safety and help prevent short circuits. Tubular contacts connect stripped, un-terminated solid or stranded wire directly to each contact. Integrated wire protectors prevent twisting and breakage of stranded wire during connection. Modular 12-circuit design can be cut into smaller sections, or stacked end-to-end. Rugged nylon 66 housing, UL 94V2. Operating temperature rated at 221°F (105°C). 12 circuits per strip.



Part #	Electrical Ratings	Wire Range (AWG)
89-608	10A/400V (CSA Certified)	20 - 18 (CSA Certified)
89-610	20A/400V (CSA Certified)	18 - 14 (CSA Certified)
89-612	35A/600V (CUL Listed)	22 - 10 (CUL Listed)
89-614	35A/600V (CUL Listed)	20 - 8 (CUL Listed)

Hardware, Terminals & Tape - Terminal Blocks & Accessories



Din Rail

Steel design. Zinc chromate plating. Two meter length. Standard packs of 20. Competitive pricing. Industry standard materials. CE approved. Six types available. No markings on rail.

Part #	Dimensions	Type
TS3575SOL	35mm x 7.5mm	Solid
TS3575SL	35mm x 7.5mm	Slotted
TS32SOL	32mm x 15mm	Solid
TS3515SOL	35mm x 15mm	Solid
TS3515SL	35mm x 15mm	Slotted
TS3515SOLH	35mm x 15mm	Solid Heavy

Feed-Through Terminals and Accessories

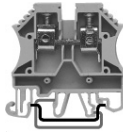

Part #	Type	Width	Description
445150	NPP, Polyamide 6.6 Beige	1.5mm	End Plate/Partition
495040	KD 3, MR 35 for Beige-Grey Beige	8mm	End Bracket

PEK Feed-Through Terminals

Manufactured from a Polyamid 6.6 material and can be used both with mounting rails MR 32 and MR 35. Nine different colors give users change to group control lines, current and voltage. For colors, replace X with: 0 (beige), 1 (blue), 2 (green), 3 (yellow), 4 (red), 5 (black), 6 (white), 7 (orange), 8 (brown).

Part #	Width	Voltage/Current/Cross-Section	UL	Insulation Stripping Length	Solid Strad, Screw Connection	Fine Strad, Screw Connection	AWG Conductor
30512(X)	6mm	750V~/26A / 2.5mm ²	600V~/26A / AWG 26-12	10mm	0,5 - 4mm ²	1,5 - 4mm ²	26-12
30513(X)	6.5mm	750V~/34A / 4 mm ²	600V~/34A / AWG 26-12	10mm	0,5 - 6mm ²	1,5 - 4mm ²	26-10
30514(X)	8mm	750V~/44A / 6mm ²	600V~/44A / AWG 26-8	12mm	0,5 - 10mm ²	1,5 - 6mm ²	26-8

Fuse Terminals

5x20 mm.

Part #	Voltage/Current/Cross-Section	Insulation Stripping Length	Solid Strad, Screw Connection	Fine Strad, Screw Connection	AWG Conductor
351100	500V~/6.3A / 6mm ²	12mm	0.5 - 10mm ²	1.5 - 6mm ²	26-8

WGT Series Earth Terminals

These terminals have an added advantage of their usage both on MR 32 and MR 35 rail. WGT series earth terminals can be used on both MR 35 and MR 32 rails. Colors are yellow-green which accomplishes international standards. Metal parts connects wire directly to rail. Insulation stripping length is 12mm. Fine strad, screw connection is 1.5 - 6mm².

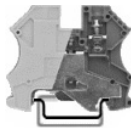

Part #	Width	Voltage/Current/Cross-Section	UL	Solid Strad, Screw Connection	AWG Conductor
331130	6mm	-V~/ -A / 4mm ²	-V~/ -A / AWG 26-10	0.5 - 6mm ²	26-10
331140	8mm	-V~/ -A / 6mm ²	-V~/ -A / AWG 26-8	0.5 - 10mm ²	20-8

Terminal Blocks

These lock together forming a continuous 5mm spacing terminal block. Housing is Polyamid 6.6. Terminals are tin plated brass. Contacts are nickel plated brass. Ratings are 8A @ 300 volts (58-10x), 10 amp @ 300 volts (58-11x). Wire size is 14 AWG maximum.



10 amp @ 300V. 14 AWG maximum.

Part #	Description
58-102-0	2 position
58-103-0	3 position

8 amp @ 300V. 14 AWG maximum.



Part #	Description
58-112-0	2 position
58-113-0	3 position

These 12 position, flexible terminal blocks can be cut to length.



Part #	Amps
58-301-0	3 amps
58-302-0	6 amps
58-303-0	15 amps

These flexible 12 position terminals blocks are made of polyamid 6 and are approved by most agencies including CSA, UL, VDE, OVE.



Part #	Wire	Voltage
58-308-0	20-10 AWG	300VAC
58-312-0	22-14 AWG	300 VAC



75 Amp Dual Row Terminal Blocks

Rating is UL and CSA 75A* @ 600V. *75A max. with pressure terminal and #4 AWG wire. Center spacing is 11/16" (.687"). wire size is #10 -14 AWG copper. Screw size is #10 - 32 combo head. Distance between barriers is .56". Material is UL rated 94VO thermoplastic. Operating temperature is 130°C (260°F) Max. -40°C (-40°F) Min. Breakdown voltage is 7500V RMS.



Part #	No. of Poles
13-1702	2
13-1703	3
13-1704	4
13-1705	5
13-1706	6
13-1707	7
13-1708	8
13-1710	10
13-1712	12



Hardware, Terminals & Tape - Terminal Blocks & Accessories



Barrier Strip Hardware



13-1400 Series

Part #	Description
13-1450	Single flat Q.D. tab .187"
13-1451	Single 45° Q.D. tab .187"
13-1452	Dual flat Q.D. tab .187"
13-1453	Dual 45° Q.D. tab .187"
13-1455	Slip-on barrier jumper

13-1500 Series

Part #	Description
13-1550	Single flat Q.D. .187"
13-1551	Single 45° Q.D. tab .187"
13-1552	Dual flat Q. D. tab .187"
13-1553	Dual 45° Q.D. tab .187"
13-1555	Slip-on barrier jumper

Terminal Blocks - Straight Type

A terminal block designed to be end-stackable on a PC board so that the designer may have any number of contacts needed. The design provides secure wire protection for a broad range of wire sizes (up to 14 ga. max.). The housing is molded of 94V-0 fire retardant plastic. Housing is Polyimide 66 resin, blue. Terminal is 0.9 x 0.9 brass, tin plated. Screw M2.6x0.45P, steel, zinc plated. Wire cage is brass, Ni plated. Rated 10 amp, 300 VAC. Temperature rating is -55°C to 125°C. Wire range is 14 AWG max. Dielectric strength is 2000 VAC min. for one minute. Insulation resistance is 500M ohm min. at 500 VDC. Pitch is 5mm. Number of poles are 2,3.



Part # TB132

20 Amp Dual Row Terminal Block

Rating is UL 20A @ 250V CSA 20A @ 150V. Center spacing is 3/8" (.375). Wire size is #14-22 AWG copper. Screw size is #6 combo head. Distance between barriers is .30". Material is UL rated 94VO thermoplastic. Operating temperature is 130°C (260°F) maximum and -40°C (-40°F) minimum. Breakdown voltage is 3600V RMS.



Part #	No. of Poles	Length (inches)
13-1402	2	1.40
13-1403	3	1.78
13-1404	4	2.16
13-1405	5	2.53
13-1406	6	2.90
13-1407	7	3.28
13-1408	8	3.66
13-1409	9	4.03
13-1410	10	4.40
13-1412	12	5.16
13-1414	14	5.90
13-1416	16	6.66
13-1418	18	7.40
13-1420	20	8.16
13-1422	22	8.90



Female DePluggable Terminal Blocks

These handy connectors are designed for quick and easy connection of wire to wire or wire to board configurations and are then unpluggable when needed and are equipped with a sturdy latch to prevent accidental disconnect. The wire entry is through the right side of the connector or vertical (right angle) to the mating connector. Rating is 15A @ 300V. UL Listed and CSA certified. Center spacing is .2" (5.08 mm). Wire size is #12 - 22 AWG. Housing material is type 6/6 polyamide 94VO. Screw size is 3 mm x 5 mm zinc plated steel. Operating temperature is 105°C (221°F) maximum and -40°C (-40°F) minimum.



Horizontal

Part #	No. of Positions	Length (mm)
13-2702	2	10.16
13-2703	3	15.24
13-2704	4	20.32
13-2705	5	25.40
13-2706	6	30.48
13-2708	8	40.64
13-2710	10	50.80
13-2712	12	60.96

Vertical

Part #	No. of Positions	Length (mm)
13-2502	2	10.16
13-2503	3	15.24
13-2504	4	20.32
13-2505	5	25.40
13-2506	6	30.48
13-2508	8	40.64
13-2510	10	50.80
13-2512	12	60.96

Euro Style Barrier Strip

These Euro style barrier strips are available in several sizes depending on your carry current needs. They are cuttable to almost any desired length. These terminal blocks are available in 6A, 10A, 16A and 32A versions. Ratings are 6A @ 400V and 10A @ 400V UL Listed and CSA Certified; 16A @ 400V and 32A @ 400V not agency approved. Screw material is tin plated steel. Housing material is type 6/6 polyamide 94VO. Operating temperature is 105°C (221°F) maximum and -40°C (-40°F) minimum.



Part #	Amp	Voltage	Length (mm)	Width (mm)	Screw Size (mm)	Wire Size (AWG)
13-1208	6A	400	95.8	6.3	2.6 x 5	18-20
13-1210	10A	400	117.5	20.2	3.0 x 6	14-18
13-1216	16A	400	140.5	23.8	3.5 x 7	10-14

Hardware, Terminals & Tape - Terminal Blocks & Accessories



30 Amp Dual Row Terminal Blocks

Rating is UL 30A @ 600V CSA 30A @ 600V. Center spacing is 9/16" (.562"). Wire size is #10 - 22 AWG copper. Screw size is #18 - 32 combo head. Distance between barriers is .41". Material is UL rated 94VO thermoplastic. Operating temperature is 130°C (260°F) Max. -40°C (-40°F) Min. Breakdown voltage is 7500V RMS.



Part #	No. of Poles
13-1602	2
13-1603	3
13-1604	4
13-1605	5
13-1606	6
13-1607	7
13-1608	8
13-1609	9
13-1610	10
13-1612	12

Heavy Duty 20 Amp Dual Row Terminal Blocks

Rating is UL 20A @ 300V and CSA 20A @ 300V. Center spacing is 7/16" (.437"). Wire size is #12-22 AWG copper. Screw size is #6 combo head. Distance between barriers is .353". Material is UL rated 94VO thermoplastic. Operating temperature is 130°C (260°F) maximum and -40°C (-40°F) minimum. Breakdown voltage is 4800V RMS.



Part #	No. of Poles
13-1502	2
13-1503	3
13-1504	4
13-1505	5
13-1506	6
13-1507	7
13-1508	8
13-1509	9
13-1510	10
13-1512	12
13-1514	14
13-1516	16
13-1518	18
13-1520	20
13-1522	22

Hardware, Terminals & Tape - Pin Headers



Headers

.100" Center Headers

6373/6410 Series Square Pin Friction Lock Headers.

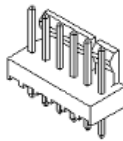

Part #	Circuits
22-23-2021	02
22-23-2031	03
22-23-2041	04
22-23-2051	05
22-23-2061	06
22-23-2071	07
22-23-2081	08
22-23-2091	09
22-23-2101	10
22-23-2111	11
22-23-2121	12
22-23-2131	13
22-23-2141	14
22-23-2151	15
22-23-2161	16
22-23-2171	17
22-23-2181	18
22-23-2201	20
22-23-2221	22
22-23-2241	24
22-23-2251	25

.100" Center Headers

7478 Series Square Pin Right Angle Friction Lock.

Part #	Circuits
22-05-3021	02
22-05-3031	03

.100" Center Headers (cont.)

Part #	Circuits
22-05-3041	04
22-05-3051	05
22-05-3061	06
22-05-3071	07
22-05-3081	08
22-05-3091	09
22-05-3101	10
22-05-3111	11

.156" Center Crimp Terminal Housing

Part #	Description	Circuits
09-50-3021	With locking ramp	02
09-50-3031	With locking ramp	03
09-50-3041	With locking ramp	04
09-50-3051	With locking ramp	05
09-50-3061	With locking ramp	06
09-50-3071	With locking ramp	07
09-50-3081	With locking ramp	08
09-50-3091	With locking ramp	09
09-50-3101	With locking ramp	10
09-50-3111	With locking ramp	11
09-50-3121	With locking ramp	12
09-50-3131	With locking ramp	13
09-50-3141	With locking ramp	14
09-50-3151	With locking ramp	15
09-50-3161	With locking ramp	16
09-50-3171	With locking ramp	17
09-50-3181	With locking ramp	18
09-50-3191	With locking ramp	19



Hardware, Terminals & Tape - Pin Headers



Headers (cont.)

.156" Center Crimp Terminal Housing

Part #	Description	Circuits
09-50-3201	With locking ramp	20
09-50-3221	With locking ramp	22
09-50-3241	With locking ramp	24
09-50-7021	Without locking ramp	02
09-50-7031	Without locking ramp	03
09-50-7041	Without locking ramp	04
09-50-7051	Without locking ramp	05
09-50-7061	Without locking ramp	06
09-50-7071	Without locking ramps	07
09-50-7081	Without locking ramp	08
09-50-7091	Without locking ramp	09
09-50-7101	Without locking ramp	10
09-50-7111	Without locking ramp	11
09-50-7121	Without locking ramp	12
09-50-7131	Without locking ramp	13
09-50-7141	Without locking ramp	14
09-50-7151	Without locking ramp	15
09-50-7161	Without locking ramp	16
09-50-7171	Without locking ramp	17
09-50-7181	Without locking ramp	18
09-50-7191	Without locking ramp	19
09-50-7201	Without locking ramp	20
09-50-7211	Without locking ramp	21
09-50-7221	Without locking ramp	22
09-50-7231	Without locking ramp	23
09-50-7241	Without locking ramp	24

.156" Center PC Board Connectors

Part #	Circuits	Type
09-52-3031	03	Tin 2145-A Right Angle Mount Type A
09-52-3051	05	Tin 2145-A Right Angle Mount Type A
09-52-3061	06	Tin 2145-A Right Angle Mount Type A
09-52-3081	08	Tin 2145-A Right Angle Mount Type A
09-52-3091	09	Tin 2145-A Right Angle Mount Type A
09-52-3101	10	Tin 2145-A Right Angle Mount Type A
09-52-3121	12	Tin 2145-A Right Angle Mount Type A
09-52-3151	15	Tin 2145-A Right Angle Mount Type A
09-62-3061	05	Gold 2145-A Right Angle Mount Type A
09-62-3081	08	Gold 2145-A Right Angle Mount Type A
09-62-3091	09	Gold 2145-A Right Angle Mount Type A
09-62-3101	10	Gold 2145-A Right Angle Mount Type A
09-62-3121	12	Gold 2145-A Right Angle Mount Type A
09-62-3151	15	Gold 2145-A Right Angle Mount Type A
09-52-3032	03	Tin 2145-B Bottom Entry Connector Type B
09-52-3042	04	Tin 2145-B Bottom Entry Connector Type B
09-52-3052	05	Tin 2145-B Bottom Entry Connector Type B
09-52-3062	06	Tin 2145-B Bottom Entry Connector Type B
09-52-3072	07	Tin 2145-B Bottom Entry Connector Type B
09-52-3082	08	Tin 2145-B Bottom Entry Connector Type B
09-52-3092	09	Tin 2145-B Bottom Entry Connector Type B
09-52-3102	10	Tin 2145-B Bottom Entry Connector Type B
09-52-3122	12	Tin 2145-B Bottom Entry Connector Type B
09-52-3152	15	Tin 2145-B Bottom Entry Connector Type B
09-62-3082	08	Gold 2145-B Bottom Entry Connector Type B
09-62-3092	09	Gold 2145-B Bottom Entry Connector Type B



Headers (cont.)

.156" Center PC Board Connectors

Part #	Circuits	Type
09-62-3102	10	Gold 2145-B Bottom Entry Connector Type B
09-62-3122	12	Gold 2145-B Bottom Entry Connector Type B
09-62-3152	15	Gold 2145-B Bottom Entry Connector Type B
09-52-3033	03	Tin 2145-C Top Entry Connector Style C
09-52-3043	04	Tin 2145-C Top Entry Connector Style C
09-52-3053	05	Tin 2145-C Top Entry Connector Style C
09-52-3063	06	Tin 2145-C Top Entry Connector Style C
09-52-3073	07	Tin 2145-C Top Entry Connector Style C
09-52-3083	08	Tin 2145-C Top Entry Connector Style C
09-52-3093	09	Tin 2145-C Top Entry Connector Style C
09-52-3103	10	Tin 2145-C Top Entry Connector Style C
09-52-3123	12	Tin 2145-C Top Entry Connector Style C
09-52-3153	15	Tin 2145-C Top Entry Connector Style C
09-62-3083	08	Gold 2145-C Top Entry Connector Style C
09-62-3103	10	Gold 2145-C Top Entry Connector Style C

Single Row Right Angle Breakway Header

Part #	Circuits
22-59-1303	03
22-59-1304	04
22-59-1306	06
22-59-1320	20
22-59-1330	30
22-59-1340	40



.100" PC Headers

Breakaway headers. 40 and 80 position standard. Available in other sizes. Gold plated.



Part #	Description
36-140G-0	40-position single row
36-280G-0	Double row (2 x 40 position)
36-340G-0	40-position right angle
36-480G-0	Double right angle (2 x 40-position)
36-100-0	Short shunt (open type)
36-101-0	Black long handle shunt
36-102-0	Red long handle shunt



.100" Centers Crimp Type Locking Connectors

Specifications: Voltage Rating: 250V AC, DC. Current Rating: 5 A AC, DC. Withstand Voltage: 1000V AC/minute. Insulation Resistance: 1000m ohm minute. Temperature Range: -25°C to 85°C. Applicable PC Board Thickness: .063" (1.6mm). Contact Resistance: Initial value/ 10 ohms Max. After environmental testing/ 20m ohms max. Materials: Post-brass/tin plate. Base-nylon 66, UL 94V-2.



Part #	Position	Width
70-4852	2	.220"
70-4854	4	.421"

Hardware, Terminals & Tape - Pin Headers



.100" Centers Locking Polarized Headers

Specifications: Voltage Rating: 250V AC, DC. Current Rating: 5 A AC, DC. Withstand Voltage: 1000V AC/minute. Insulation Resistance: 1000m ohm minute. Temperature Range: -25°C to 85°C. Applicable PC Board Thickness: .063" (1.6mm). Contact Resistance: Initial value/10 ohms max. After environments testing/ 20m ohms max. Material: Post- Brass/tin plate. Base-Nylon 66, UL 94V-0.

Part #	Position	Width
70-4802	2	.200"
70-4804	4	.400"



.156" Centers Crimp Type Locking Connectors

Specifications: Voltage Rating: 250V AC, DC; Current Rating: 5 A AC, DC; Withstand Voltage: 1000V AC/minute; Insulation Resistance: 1000m ohm minute; Temperature Range: -25°C to +85°C; Applicable PC Board Thickness: .063" (1.6mm); Contact Resistance: Initial value/ 10 ohms Max. After environmental testing/20m ohms max. Materials: Post-brass/tin plate. Base-nylon 66, UL 94V-2.

Part #	Position	Width
70-6854	4	.624"
70-6858	8	1.248"

Hardware, Terminals & Tape - Tape



EMI/RFI Copper Shielding Tape

Copper shielding tape is a copper foil tape backed with a highly conductive pressure-sensitive adhesive for use in a wide variety of commercial EMI/RFI shielding applications. Choose for EMI/RFI shielding applications; highly conductive, pressure-sensitive adhesive seal; point-to-point electrical continuity; low-resistance adhesive. Tensile strength is 21 lbs/inch. Adhesion is 40 oz/inch. Thickness is 0.003 inch. Flame retardant per UL Standard 510. Electrical resistance through tape is 0.003 ohms/inch². Shielding effectiveness is 50 dB at 153 MHz. UL Standard 510, MIL-Standard 202C, Method 303 and ASTM-D-1000. Standard package is one roll (36 yards).



Part #	Width inches (mm)
CST-10	1.0 (25,4)
CST-15	1.5 (38,1)
CST-20	2.0 (50,8)
CST-5	0.5 (12,7)



Double-Sided Mounting Tape

Designed for semi-permanent and removable applications.



Part #	Description
LT-01528	3/4" x 10' removable
LT-HU-1	1" x 60' roll
LT-HU15-6	3/4" x 15' roll

667 Pro Series Vinyl Electrical Tape

This is a complete line of professional grade electrical tape. UL and CSA Approved. Available in ten colors designed for electrical coding and splicing applications. Flame-retardant. 7 Mil vinyl. Weather-resistant. Up to 600 V rating. Temperature range is -18°C to 105°C (0°F to 221°F). Resists abrasion, moisture, solvents and UV rays. Convenient 3/4" x 66' size.



Part #	Color
LT-04140	Green
LT-04141	White
LT-04142	Yellow
LT-04143	Red
LT-04144	Blue
LT-04145	Orange
LT-04147	Gray
LT-04149	Black



Vinyl Electrical Tape

Designed to compete with the imports, however, the stretch, adhesion and weather-resistant qualities are far superior.



Part #	Description	Availability
LT-1219-60	Economy	3/4" x 60'
LT-07205	Assorted	Comes in 5 colors, 1/2" x 20' each

Color Duck Tape

Wide range of colors which can be used to repair just about anything including seats, luggage, bags and books just to name a few. Professional grade. Excellent adhesive, conformability, unwind and tear features. Nine colors coordinating with most anything.



Part #	Length	Color
LT-CD-1BG	2" x 5yd	Beige
LT-CD-1BLK	2" x 5yd	Black
LT-CD-1BLU	2" x 5yd	Blue
LT-CD-1BRN	2" x 5yd	Brown
LT-CD-1GRN	2" x 5yd	Green
LT-CD-1RED	2" x 5yd	Red
LT-CD-1SIL	2" x 5yd	Silver
LT-CD-1WHT	2" x 5yd	White
LT-CD-1YEL	2" x 5yd	Yellow
LT-CD3BRN	2" x 20yd	Brown
LT-CD3GRN	2" x 20yd	Green
LT-CD3HCBK	2" x 20yd	High cont. black
LT-CD3HCWH	2" x 20yd	High cont. white
LT-CD3RED	2" x 20yd	Red
LT-CD3WHT	2" x 20yd	White

Duck Tape

Just because it looks like Duck tape, feels like Duck tape and tears like duct tape does not mean they all are the same. There are as many types of Duck tape as there are ducks. Several grades depending on the usage.



Part #	Description	Grade
LT-B100	1.88" x 10yd roll	All-purpose
LT-B200	1.88" x 20yd roll	All-purpose
LT-B300	1.88" x 30yd roll	All-purpose
LT-B615	1.88" x 60yd roll	All-purpose
LT-DX-660	1.88" x 55yd roll	Utility
LT-S-10	2" x 10yd flat	Professional
LT-B450	1.88" x 45yd roll	All-purpose



Hardware, Terminals & Tape - Tape



Liquid Electrical

Forms a protective, water-proof, UV resistant, dielectric coating. Prevents corrosion on wires and terminals. Patented, UL tested, fast drying formula. 4 flow oz. cans.

Part #	Description
9040-E	Black
9040 3-E	Green
9040 5-E	Red
9040 6-E	White

Self-Bonding Splice

This rubber splicing tape is a self-amalgamating, low voltage rubber tape which is UL approved for use as primary insulation at not more than 600 volts. It easily conforms to irregular shapes and surfaces yielding a void free, electrical stable build-up. It is compatible with all extruded dielectric cable insulation's. 3.4" x .030" x 22' (19mm x .76mm x 7mm).

Part #	Description
3465-E	1 roll
3465-RL	10 rolls
3465-CS	100 rolls

Thread Seal - 1/2" x 480"

Part #	Description
3467-E	1 roll
3467-BX	12 rolls

PVC Insulating Tape

All weather PVC insulating tape. Approved at 7°C to 80°C. 7 Mil thick, 3/4" wide. Each roll is individually cello wrapped.

Part #	10 Rolls	300 Rolls	Color/Length
3433 0-E	3433 0-RL	3433 0-35	Black 33'
3466 0-E	3466 0-RL	3466 0-35	Black 66'
3466 1-E	3466 1-RL	3466 1-35	Blue 66'
3466 3-E	3466 3-RL	3466 3-35	Green 66'
3466 4-E	3466 4-RL	3466 4-35	Orange 66'
3466 5-E	3466 5-RL	3466 5-35	Red 66'
3466 6-E	3466 6-RL	3466 6-35	White 66'
3466 7-E	3466 7-RL	3466 7-35	Yellow 66'

Welding Compound

Repairs, fills, bonds iron, steel, copper, aluminum, brass, plastic, bronze, pewter, wood, porcelain, ceramic.

Part #	Description
9035-E	1 piece
9035-CT	Box of 6

Hardware, Terminals & Tape - Cable Grips



Tight Seal' IP68 Nylon Cable Grips

Wider domed nut which can not be over-tightened. Generous deep flats. Spacer. Neoprene rubber seal. Webs are staggered for better grip. Sprung webs. Retention springs for domed nut. Sealing lip. Anti-twist cable locking collet.



Thread type is Metric. Color is black.

Part #	Cable Diameter - Ins. (mm)	Wrench Size (mm)	Dimensions - H (mm), L (mm)	Size
1545.12.06	0.10-0.26 (2.5-6.5)	15	21,8	12 x 1.5
1545.17.08	0.12-0.31 (3.0-8.0)	19	23,8	16 x 1.5
1545.20.07	0.12-0.28 (3.0-7.0)	24	26,9	20 x 1.5
1545.20.12	0.22-0.47 (5.5-12.0)	24	26,9	20 x 1.5
1545.25.14	0.26-0.55 (6.5-14.0)	33	35,11	25 x 1.5
1545.25.18	0.43-0.71 (11.0-18.0)	33	35,11	25 x 1.5
1545.32.25	0.67-0.98 (17.0-25.0)	42	36,11	32 x 1.5

Thread type is NPT. Color is black.

Part #	Cable Diameter - Ins. (mm)	Wrench Size (mm)	Dimensions - H (mm), L (mm)	Size
1545.N0375.08	0.12-0.31 (3.0-8.0)	19	23,8	3/8
1545.N0500.07	0.12-0.28 (3.0-7.0)	24	26,9	1/2

Tight Seal' IP68 Nylon Cable Grips

Thread type is NPT. Color is black. (cont.)

Part #	Cable Diameter - Ins. (mm)	Wrench Size (mm)	Dimensions - H (mm), L (mm)	Size
1545.N0500.12	0.22-0.47 (5.5-12.0)	24	26,9	1/2
1545.N0750.14	0.26-0.55 (6.5-14.0)	33	35,11	3/4
1545.N0750.18	0.43-0.71 (11.0-18.0)	33	35,11	3/4
1545.N1000.22	0.67-0.87 (17.0-22.0)	42	36,15	1

Thread type is PG. Color is black

Part #	Cable Diameter - Ins. (mm)	Wrench Size (mm)	Dimensions - H (mm), L (mm)	Size
1545.07.06	0.10-0.26 (2.5-6.5)	15	21, 8	7
1545.09.08	0.12-0.31 (3.0-8.0)	19	23, 8	9
1545.11.07	0.08-0.28 (2.0-7.0)	22	22, 8	11
1545.11.10	0.16-0.39 (4.0-10.0)	22	22, 8	11
1545.13.07	0.12-0.28 (3.0-7.0)	24	26, 9	13
1545.13.12	0.22-0.47 (5.5-12.0)	24	26, 9	13



